

FANTIC MOTOR



Fantic 160.00.1603 - CABALLERO 50 cc REGOLARITÀ COMPETIZIONE

A1

NUMERO CATALOGO 160.94.5220
NUMERO CATALOGUE 160.94.5220
CATALOG NUMBER 160.94.5220
KATALOG NUMBER 160.94.5220

FANTIC MOTOR



CABALLERO 50cc REGOLARITA' COMPETIZIONE

CATALOGO PARTI DI RICAMBIO

6 - 1979

CATALOGUE DE PIECES DE RECHANGE

6 - 1979

SPARE PARTS CATALOG

6 - 1979

ERSATZTEILE KATALOG

6 - 1979

A2

DATI D'IDENTIFICAZIONE
DONNEES D'IDENTIFICATION
IDENTIFICATION VEHICLE
LAGE VON TYPSCHEID RAHMENNUMMER

FANTIC
MOTOR



CABALLERO 50cc REGOLARITA' COMPETIZIONE

TIPO DI VEICOLO E NUMERO DI TELAIO
MODELE DE VEHICULE ET NUMERO DE CADRE
VEHICLE TYPE AND FRAME NUMBER
FAHRZEUG-TYP UND RAHMENNUMMER

FANTIC TX-160

DGM 14787 OM

☆0002479☆

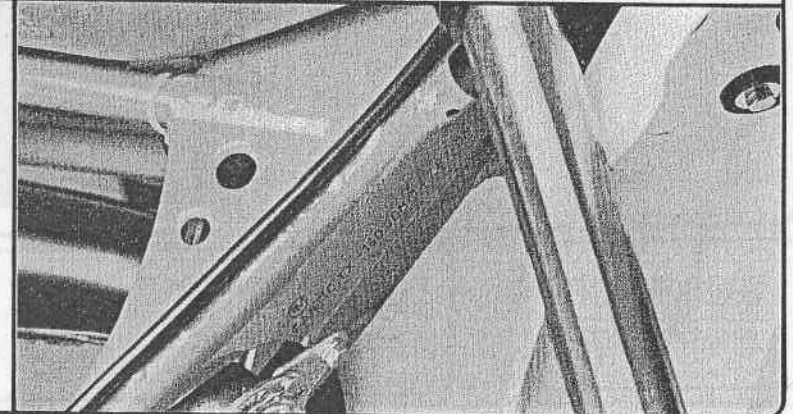

A3

INTERPRETAZIONE DEI SIMBOLI E DELLE ESPRESSIONI CODIFICATE ADOTTATE

FANTIC MOTOR

| | |
|--------------------------------|---|
| N° | = Numero ordinazione |
| Tav. | = Tavola |
| P+N°... | = Numero d'ordinazione particolari postmodifica |
| A+N°... | = Numero d'ordinazione particolari antemodifica |
| P <u>Tav. E3/2</u> | = Tavola E3/2 contenente particolari postmodifica |
| A <u>Tav. E3/1</u> | = Tavola E3/1 contenente particolari antemodifica |
| → <u>0001500</u> | = La tavola (od il particolare) vale fino al veicolo con numero di telaio 0001500 |
| <u>0001501</u> → | = La tavola (od il particolare) vale dal veicolo con numero di telaio 0001501 |
| <u>A+B+...</u> N° | = Confezione ricambi composta dai particolari A+B+... illustrati nella tavola |
| 190.01.5200 } 191.01.5200 } | = In alternativa |
| 319.11.5000 ⁺ | = Parte specifica di una versione di esportazione; consultare in calce alla tavola e la pagina A7 per la validità |
| 322.47.5210+2/10 | = Particolare con indicazione della maggiorazione di 2/10 |
| 155.43.8030 ≠ 0,4 | = Particolare con indicazione dello spessore di 0,4 mm. |
| 310.15.5140 d. | = Particolare destro |
| 310.15.5150 s. | = Particolare sinistro |
| 250.01.5000 | } rispetto al senso di marcia del veicolo |
| Z=... | = Parte sostituita o eliminata |
| (X) N°... | = Numero dei denti |
| V | = Dopo esaurimento fornire N°... |
| W | = Volt |
| <u>R</u> | = Watt |
| <u>SG</u> | = A richiesta |
| <u>SP</u> | = Serie guarnizioni completa |
| <u>a</u> | = Serie premistoppa motore completa |
| <u>p</u> | = Anteriore |
| <u>1</u> | = Posteriore |
| <u>2</u> | = 1^ velocità |
| <u>3</u> | = 2^ velocità |
| <u>4</u> | = 3^ velocità |
| <u>5</u> | = 4^ velocità |
| <u>6</u> | = 5^ velocità |
| <u>SD</u> | = 6^ velocità |
| <u>M 6x16</u> | = Serie decalcomanie veicolo completa |
| <u>M 6</u> | = Diametro e lunghezza delle viti di uso comune non fornite come ricambio |
| <u>∅ 6x18</u> | = Diametro dei dadi di uso comune non forniti come ricambio |
| | = Diametro interno (6) e diametro esterno (18) delle rondelle di uso comune non fornite come ricambio |

| | |
|---|---|
| N° | = Numéro de pièce |
| Tav. | = Planche |
| P+N° ... | = Numéro de pièce nouveau montage |
| A+N° ... | = Numéro de pièce ancien montage |
| P Tav. E3/2 | = Planche E3/2 regroupant des pièces nouveau montage |
| A Tav. E3/1 | = Planche E3/1 regroupant des pièces ancien montage |
| → 0001500 | = La planche (ou la pièce) est applicable jusqu'à le véhicule numéro de cadre 0001500 |
| 0001501 → | = La planche (ou la pièce) est applicable depuis le véhicule numéro de cadre 0001501 |
| A+B+... N° | = Collection de pièces comprenant les pièces A+B+... illustrées par la planche |
| 190.01.5200 } 191.01.5200 } | = Pièces montées en parallèle |
| 319.11.5000 ⁺ | = Equipements spéciaux d'exportation (voir au bas de la planche et à la page A7 l'application en fonction des destinations) |
| 322.47.5210+2/10 | = Pièce cote majorée de 2/10 |
| 155.43.8030 ≠ 0,4 | = Pièce d'une épaisseur de 0,4 mm. |
| 310.15.5140 d. | = Pièce droite } dans le sens de marche |
| 310.15.5150 s. | |
| 250.01.5000 | = Pièces remplacées ou supprimées |
| Z=... | = Numéro de cames |
| <input checked="" type="checkbox"/> N° ... | = Après épuisement prévoir N° ... |
| V | = Volt |
| W | = Watt |
| R | = En option |
| SG | = Jeu de joint complète |
| SP | = Jeu de presse-étoupe moteur complète |
| a | = Avant |
| p | = Arrière |
| 1 | = 1ère vitesse |
| 2 | = 2e vitesse |
| 3 | = 3e vitesse |
| 4 | = 4e vitesse |
| 5 | = 5e vitesse |
| 6 | = 6e vitesse |
| SD | = Jeu de decal véhicule complète |
| M 6x16 | = Diamètre et longueur des vis d'usage commun pas fournies pour rechange |
| M 6 | = Diamètre des écrous d'usage commun pas fournies pour rechange |
| ∅ 6x18 | = Diamètre intérieur (6) et extérieur (18) des rondelles d'usage commun pas fournies pour rechange |

A5

WORDING AND SYMBOL CODE

FANTIC MOTOR

| | |
|---|--|
| N° | = Part number |
| Tav. | = Table |
| P+N°... | = Part number post-modification components |
| A+N°... | = Part number pre-modification components |
| P Tav.E3/2 | = Table E3/2 including post-modification components |
| A Tav.E3/1 | = Table E3/1 including pre-modification components |
| → 0001500 | = Table (or component) applicable up to chassis N°0001500 |
| 0001501 → | = Table (or component) applicable from chassis N°0001501 |
| A+B+... N° | = Kit including parts A+B+... as shown at the table |
| 190.01.5200 } 191.01.5200 } | = Alternatives |
| 319.11.5000 ⁺ | = Component applicable to one model only; of export for applicability see footnote and page A7 |
| 322.47.5210+2/10 | = Component's oversize stated: 2/10 |
| 155.43.8030 ≠ 0,4 | = Component's thickness stated: 0,4 mm. |
| 310.15.5140 d. | = Right-hand component |
| 310.15.5150 s. | = Left-hand component |
| } with respect to vehicle's forward direction | |
| 250.01.5000 | = Deleted or superseded part |
| Z=... | = Teeth number |
| ⊗ N°... | = When depleted superseded by... |
| V | = Volt |
| W | = Watt |
| R | = Optional |
| SG | = Gasket series |
| SP | = Engine oil seal series |
| a | = Front |
| p | = Rear |
| 1 | = 1st speed |
| 2 | = 2nd speed |
| 3 | = 3rd speed |
| 4 | = 4th speed |
| 5 | = 5th speed |
| 6 | = 6th speed |
| SD | = Vehicle decal series |
| M 6x16 | = Diameter and length of the screw of common use not furnished as spare parts |
| M 6 | = Diameter of the nuts of common use not furnished as spare parts |
| ∅ 6x18 | = Interieur (6) and external (18) diameter of the washers of common use not furnished as spare parts |

A6

BEDEUTUNG DER VERWENDETEN SYMBOLE UND KURZBEZEICHNUNGEN

FANTIC MOTOR

| | |
|---|---|
| N° | = Best. Nr. |
| Tav. | = Tafel |
| P+N° ... | = Best. Nr. Teile nach Änderung |
| A+N° ... | = Best. Nr. Teile vor Änderung |
| P <u>Tav. E3/2</u> | = Tafel E3/2 enthält Teile abgeänderte Teile |
| A <u>Tav. E3/1</u> | = Tafel E3/1 enthält ungeänderte Teile |
| → <u>0001500</u> | = Tafel bzw. Teil gilt bis Fahrzeug mit Fahrgestell Nr. 0001500. |
| <u>0001501</u> → | = Tafel bzw. Teil gilt ab Fahrzeug mit Fahrgestell Nr. 0001501 |
| <u>A+B+...</u> N° | = Ersatzteilkonfektion mit den in der Tafel abgebildeten A+B+... usw. |
| 190.01.5200 } 191.01.5200 } | = in Alternative |
| 319.11.5000 ⁺ | = Spezial teil einer ausführung fuer export; fuer Verwendbarkeit siehe Notitz am Fusse der Tafel und Seite A7 |
| 322.47.5210+2/10 | = Teil mit Angabe einer Mehrlänge von 2/10 |
| 155.43.8030 ≠ 0,4 | = Teil mit Dickenangabe von 0,4 mm. |
| 310.15.5140 d. | = rechtes Teil |
| 310.15.5150 s. | = linkes Teil |
| } gegenüber der Fahrtrichtung des Fahrzeugs | |
| 250.01.5000 | = Ersetzt |
| Z=... | = Anzahl Zache |
| <input checked="" type="checkbox"/> N° ... | = falls, vergriffen, Lieferung von ... |
| V | = Volt |
| W | = Watt |
| <u>R</u> | = auf Wunsch |
| <u>SG</u> | = Komplette Serie Dichtungen |
| <u>SP</u> | = Komplette Serie Motor Oldichtungen |
| <u>a</u> | = Vorne |
| <u>p</u> | = Hinten |
| <u>1</u> | = 1. Gang |
| <u>2</u> | = 2. Gang |
| <u>3</u> | = 3. Gang |
| <u>4</u> | = 4. Gang |
| <u>5</u> | = 5. Gang |
| <u>6</u> | = 6. Gang |
| <u>SD</u> | = Komplette Serie Abziehbilder der Fahrzeugs |
| <u>M 6x16</u> | = Durchmesser und Laenge der gebrauchlichen Schrauben die nicht als Ersatz geliefert werden |
| <u>M 6</u> | = Durchmesser der gebrauchlichen Muttern, die nicht als Ersatz geliefert werden |
| <u>∅ 6x18</u> | = Innen (6) und aussen (18) Durchmesser der gebrauchlichen Ringe die nicht Ersatz geliefert werden |

A7VALIDITA '
APPLICATION DES EQUIPEMENT SELON LE PAYS DE DESTINATION
VALIDITY
GULTIGKEIT**FANTIC
MOTOR**

| | VARIANTI PER: | EQUIPEMENT POUR: | VARIANTS: | ABGELEITETE TYPEN: |
|-----|----------------|------------------|------------------------|--------------------|
| A | AUSTRIA | AUTRICHE | AUSTRIA | OSTERREICH |
| B | BELGIO | BELGIQUE | BELGIUM | BELGIEN |
| CY | CIPRO | CHYPRE | CYPRUS | ZYPERN |
| DK | DANIMARCA | DANEMARK | DENMARK | DÄNEMARK |
| F | FRANCIA | FRANCE | FRANCE | FRANKREICH |
| SF | FINLANDIA | FINLANDE | FINLAND | FINNLAND |
| D | GERMANIA | ALLEMAGNE | GERMANY | DEUTSCHLAND |
| J | GIAPPONE | JAPON | JAPAN | JAPAN |
| JOR | GIORDANIA | JORDANIE | JORDAN | JORDAN |
| GB | GRAN BRETAGNA | GRANDE BRETAGNE | ENGLAND | ENGLAND |
| GR | GRECIA | GRECE | GRÉECE | GRIECHENLAND |
| ISR | ISOLE RIUNIONE | LA REUNION | REUNION ISLAND | REUNION |
| L | LUSSEMBURGO | LUXEMBOURG | LUXEMBURG | LUXEMBURG |
| N | NORVEGIA | NORVEGE | NORWAY | NORWEGEN |
| NL | OLANDA | HOLLANDE | HOLLAND | HOLLAND |
| E | SPAGNA | ESPAGNE | SPAIN | SPANIEN |
| USA | STATI UNITI | ETATS-UNIS | UNITED STATES AMERICAN | VEREINIGTE STAATEN |
| S | SVEZIA | SUEDE | SWEDEN | SCHWEDEN |
| CH | SVIZZERA | SUISSE | SWITZERLAND | SCHWEIZ |
| | | | | |

B**CABALLERO 50 cc**
REGOLARITÀ COMPETIZIONE

6 - 1979

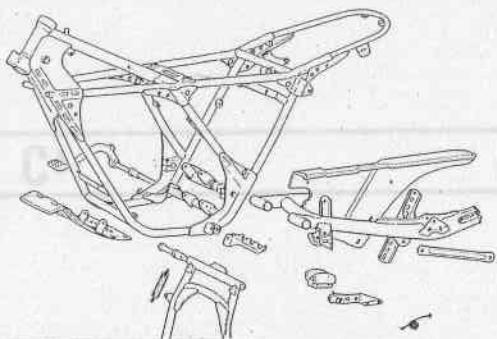
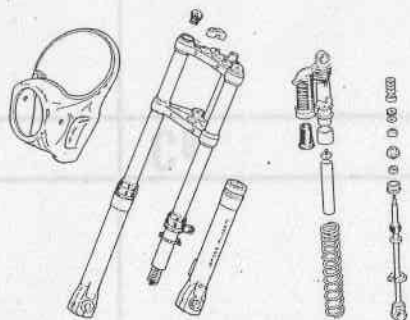
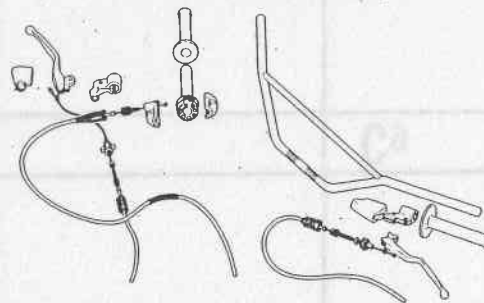
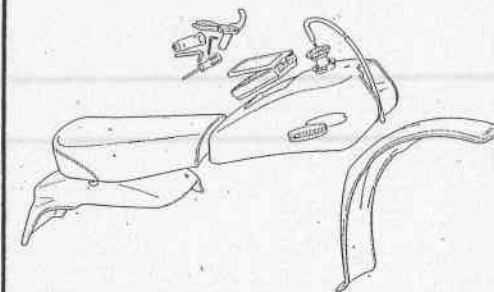
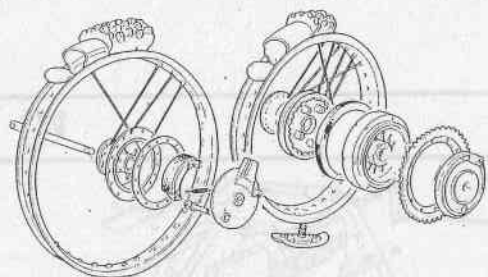
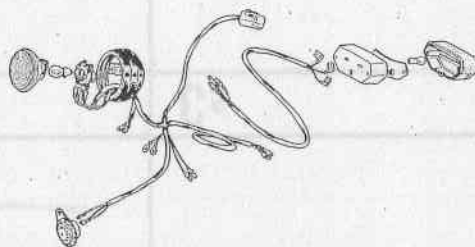
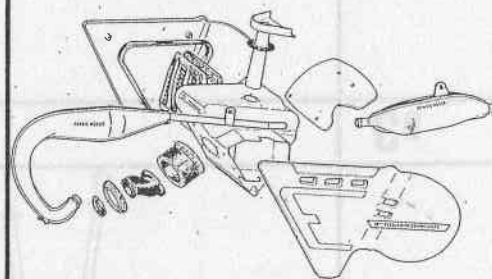
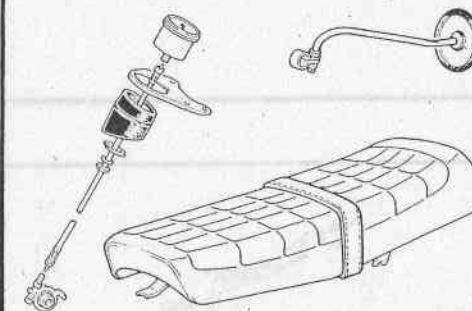
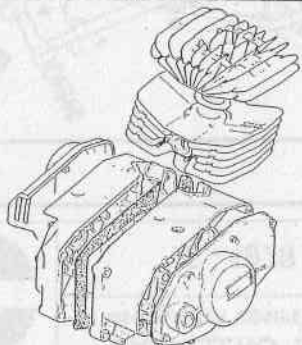
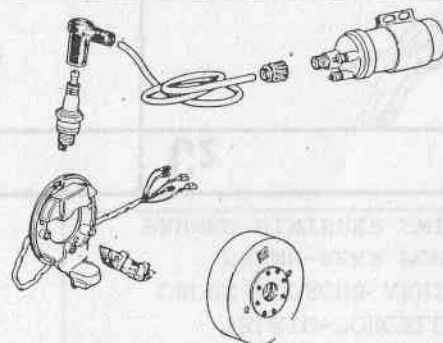
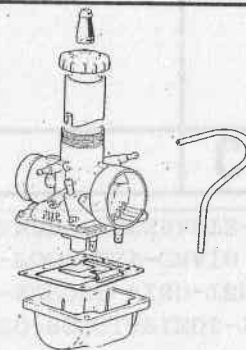
INDICE GRAFICO GENERALE
REPERTOIRE ILLUSTRÉ GENERAL
GENERAL TABLE
ALLGEMEINES GRAPHISCHES VERZEICHNIS**FANTIC
MOTOR****C****D****E****F****G****H****L****M****N****O****P****Q****LAVORI
EVOLUCI**

C**CABALLERO 50 cc**
REGOLARITÀ COMPETIZIONE

6 - 1979

TELAIO-FORCELLONE-CAVALLETTO-POGGIAPIEDI-TENDICATENA
 CADRE-FOURCHE ARRIERE-BEQUILLE-REPOSE-PIED-TENDEUR DE CHAINE
 FRAME-REAR FORK-PROP STAND-FOOTREST-CHAIN TENSIONER
 RAHMEN-HINTERER SWINGARM-KIPPSTANDER-FUSSRASTE-KETTENSANNER

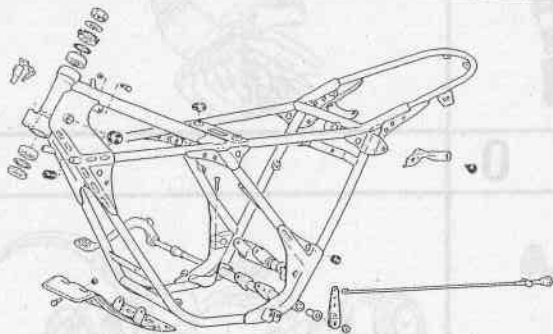
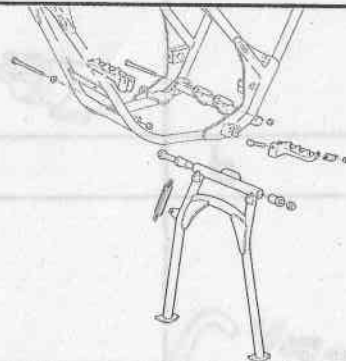
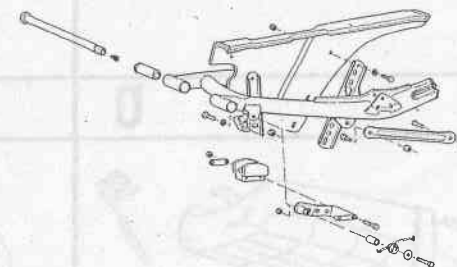
**FANTIC
MOTOR****C1****C2****C3****C4****C5****C6****C7****C8****C9****B**

6 - 1979
 REGOLARITÀ COMPETIZIONE
 CABALLERO 50 cc

REGOLARITÀ COMPETIZIONE
 CABALLERO 50 cc
 6 - 1979

**FANTIC
MOTOR**

C1

CABALLERO 50 cc
 REGOLARITÀ COMPETIZIONE
 6 - 1979

C

1/1

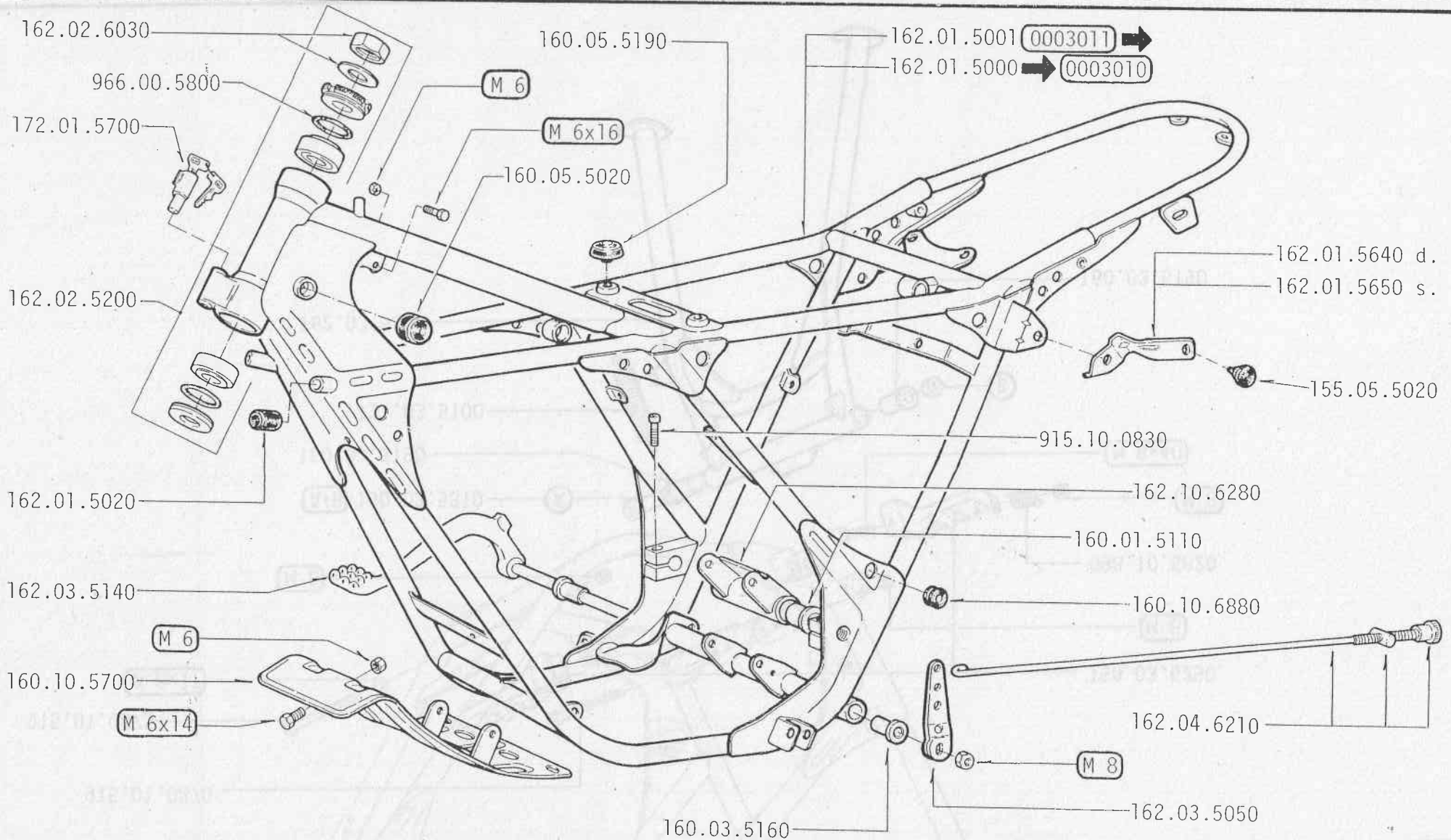
**FANTIC
MOTOR****C3**

6 - 1979
 REGOLARITÀ COMPETIZIONE
 CABALLERO 50 cc

C

1/1

**FANTIC
MOTOR**

C3**CABALLERO 50 cc**
REGOLARITÀ COMPETIZIONE

6 - 1979

C

3/1

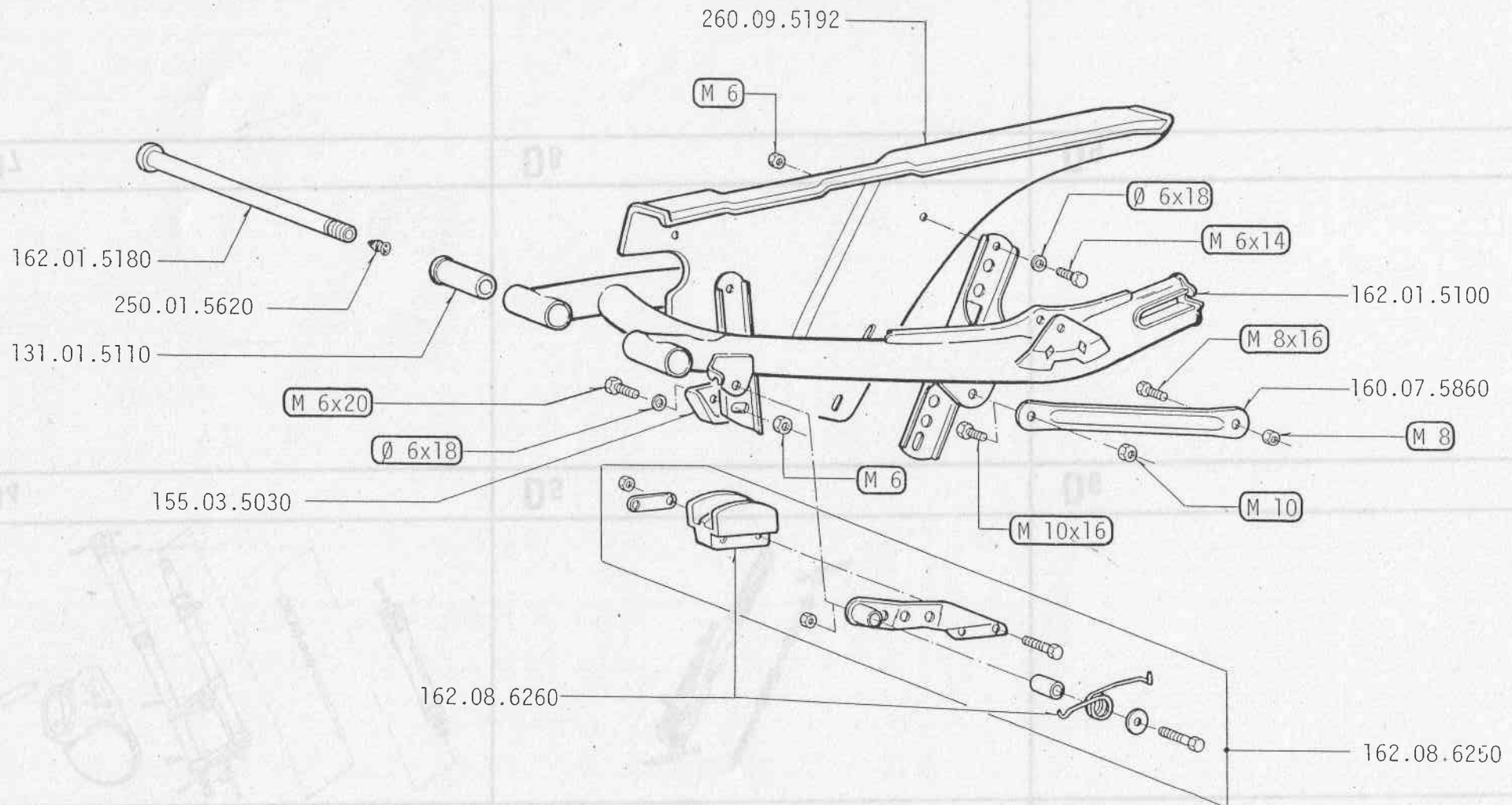
FANTIC
MOTOR

D**CABALLERO 50 cc**
REGOLARITÀ COMPETIZIONE

6 - 1979

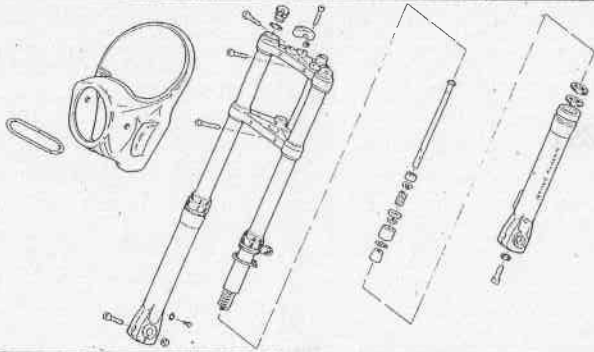
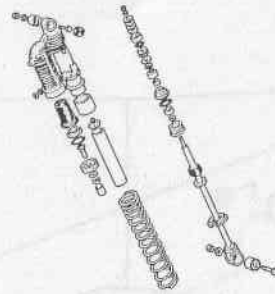
FORCELLA ANTERIORE - AMMORTIZZATORI POSTERIORI
FOURCHE AVANT - AMORTISSEUR ARRIER
FRONT FORK - REAR SHOCK ABSORBER
VORDERE RADGABEL - HINTERER STROSSDÄMPFER**FANTIC
FMOTOR****D1****D2****D3****D4****D5****D6****D7****D8****D9****C3**

6 - 1979

REGOLARITÀ COMPETIZIONE

C

31

**LINO
EVALLIC**

D1**CABALLERO 50 cc**
REGOLARITÀ COMPETIZIONE

6 - 1979

D

1/1

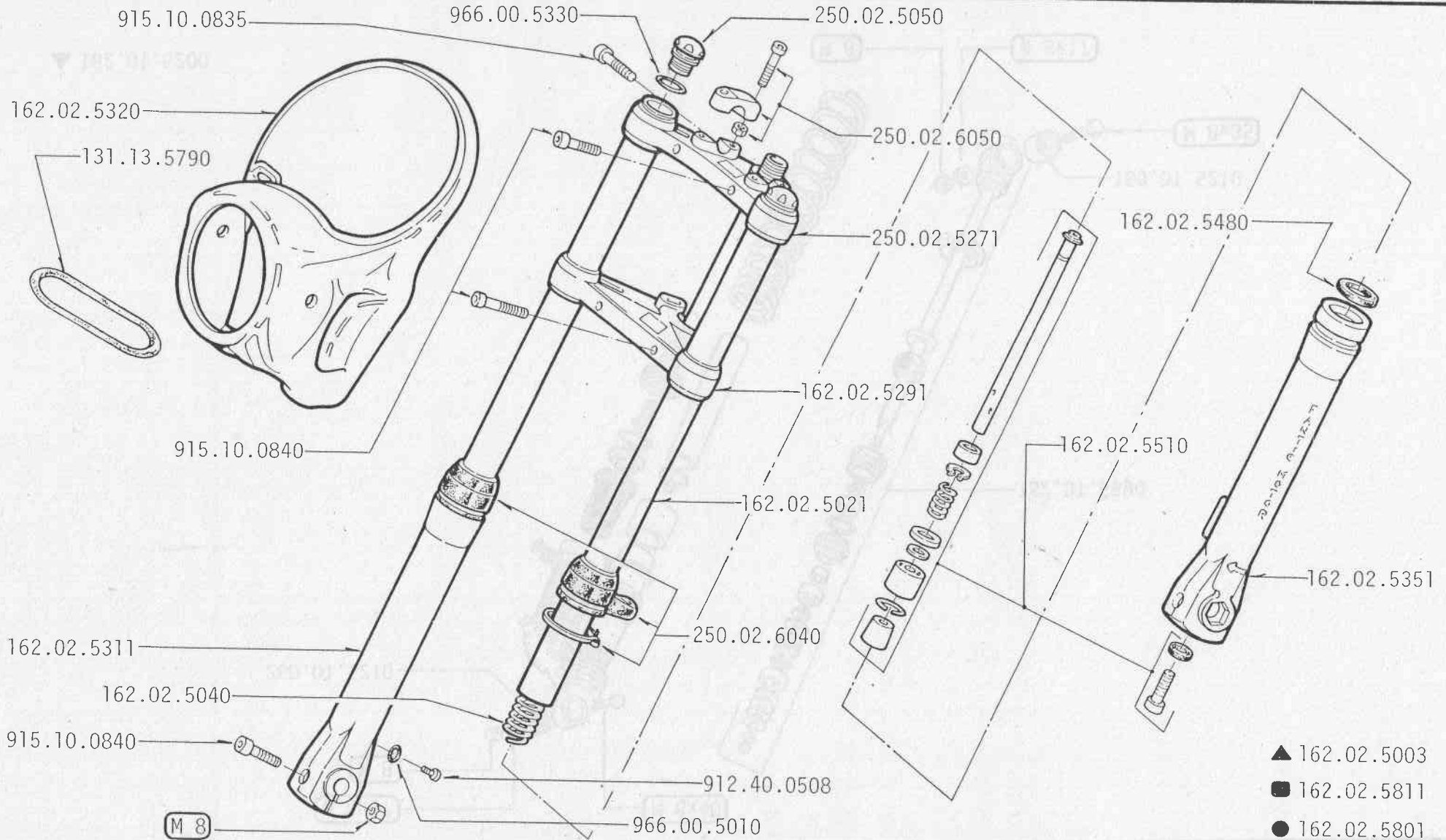
**FANTIC
MOTOR**

▲ 162.02.5003

■ 162.02.5811

● 162.02.5801

- ▲ Forcella anteriore completa
- Gamba destra forcella completa
- Gamba sinistra forcella completa

- ▲ Fourche avant complète
- Jambe droite complète
- Jambe gauche complète

- ▲ Fork complet
- Fork leg complete R/H
- Fork leg complete L/H

- ▲ Vordere Radgabel komplett
- Rechtes Gabelbein komplett
- Linkes Gabelbein komplett

D2**CABALLERO 50 cc**
REGOLARITÀ COMPETIZIONE

6 - 1979

D

2/1

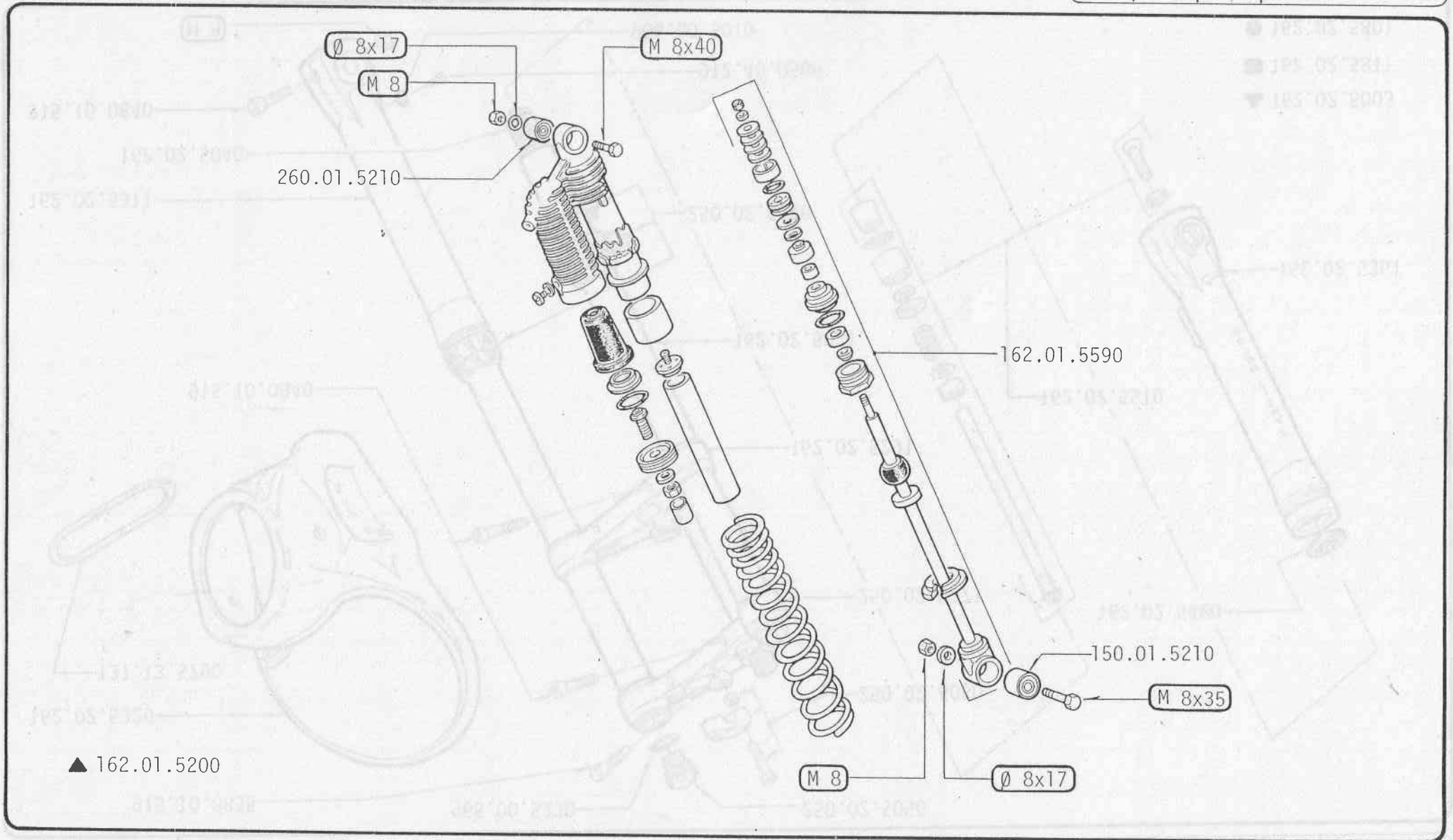
**FANTIC
MOTOR**

▲ 162.01.5200

▲ Ammortizzatore completo ▲ Amortisseur complet ▲ Rear shock absorber complet ▲ Hinterer Stossdämpfer Komplett

F1

CABALLERO 50 cc

REGOLARITÀ COMPETIZIONE

6 - 1979

F

1/1

**FANTIC
MOTOR**

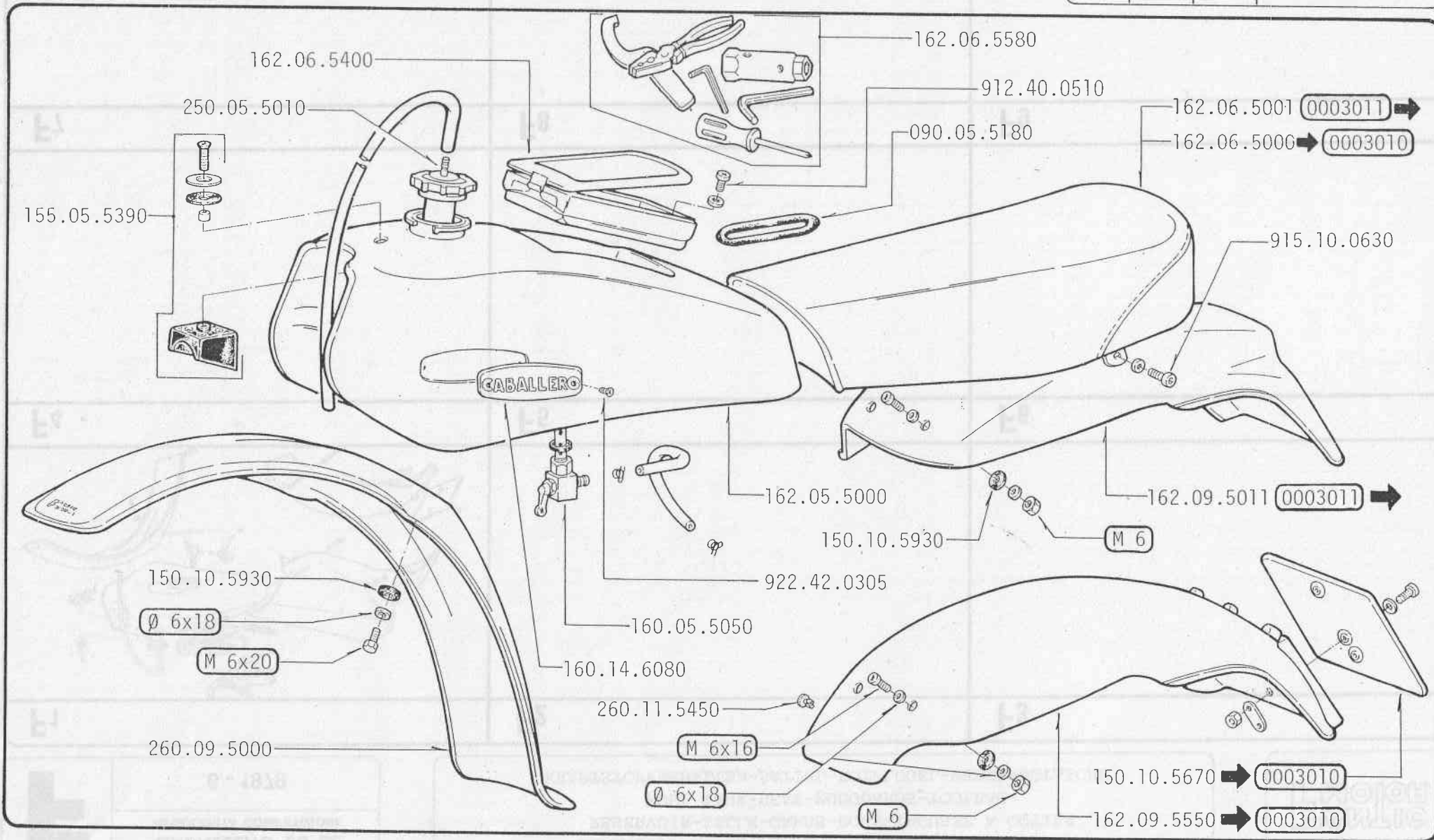

G**CABALLERO 50 cc**
REGOLARITÀ COMPETIZIONE

6 - 1979

RUOTA ANTERIORE - RUOTA POSTERIORE
 ROUE AVANT - ROUE ARRIERE
 FRONT WHEEL - REAR WHEEL
 VORDERRAD - HINTERRAD

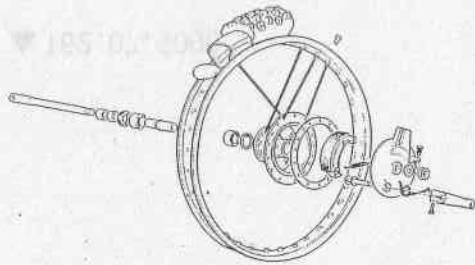
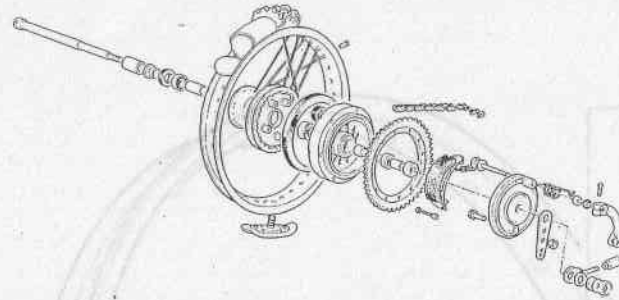
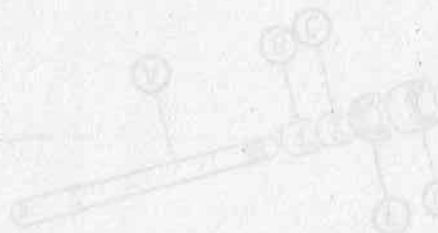
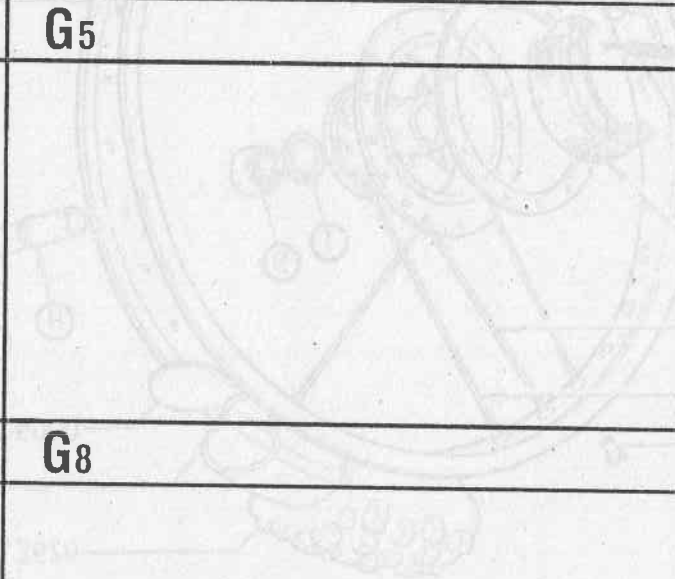
**FANTIC
MOTOR****G1****G2****G3****G4****G5****G6****G7****G8****G9**

EXTRA 1000
 EXTRA 1500

**FANTIC
MOTOR**

G1

CABALLERO 50 cc
REGOLARITÀ COMPETIZIONE

6 - 1979

G

1/1

FANTIC MOTOR

A+B+C+D+E 162.07.6600

F+G+H+G+I 150.07.6650

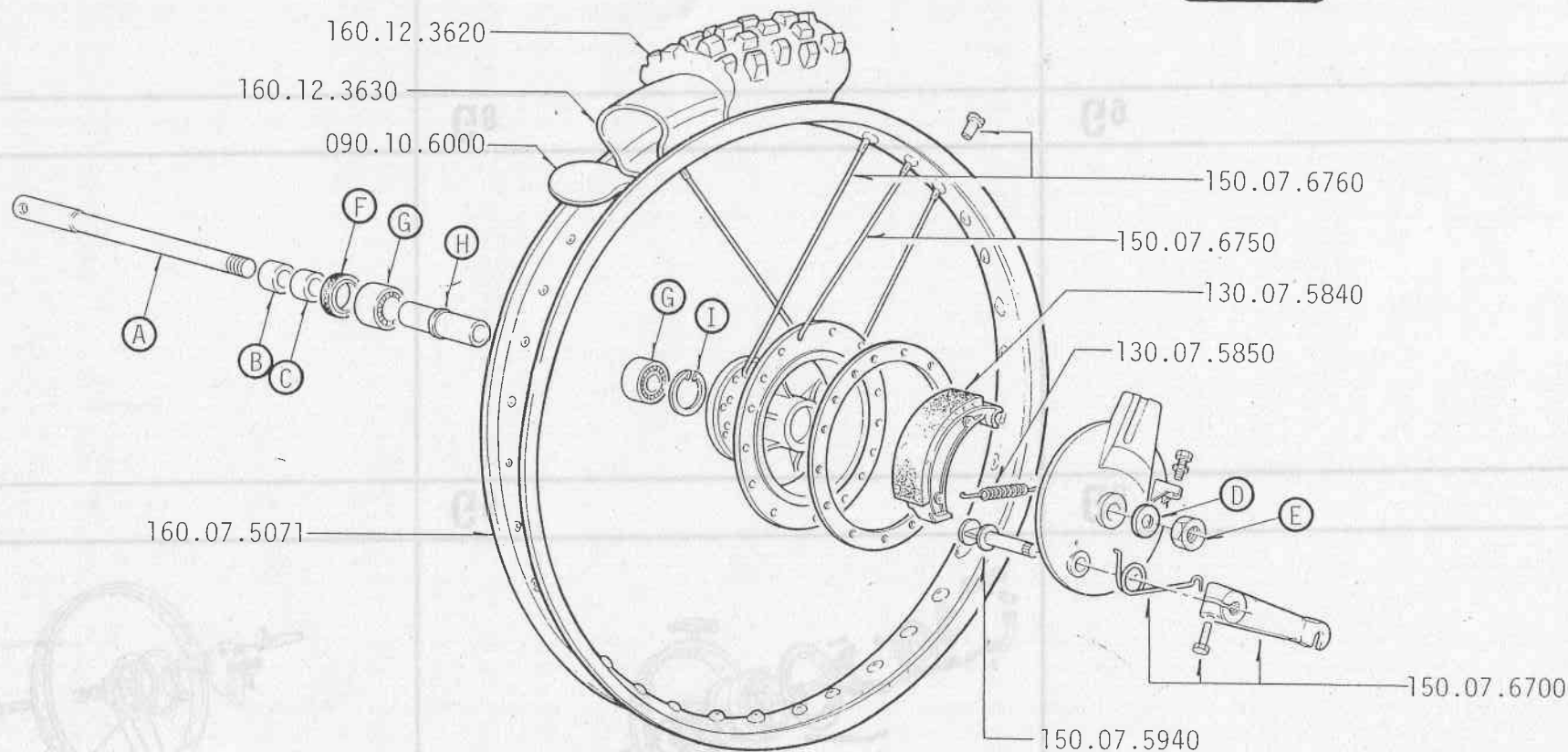

▲ 162.07.5000

■ 162.07.5060

● 160.07.5900

▲ Ruota anteriore completa
■ Mozzo anteriore completo
● Disco portaceppi completo

▲ Roue avant complète
■ Moyeu avant complet
● Disque porte-machoirs complet

▲ Front wheel complete
■ Front hub complete
● Front brake plate complete

▲ Vorderrad Komplett
■ Vorderradnabe Komplett
● Bremsplatte Komplett

G2
CABALLERO 50 cc
 REGOLARITÀ COMPETIZIONE
 6 - 1979
G

2/1

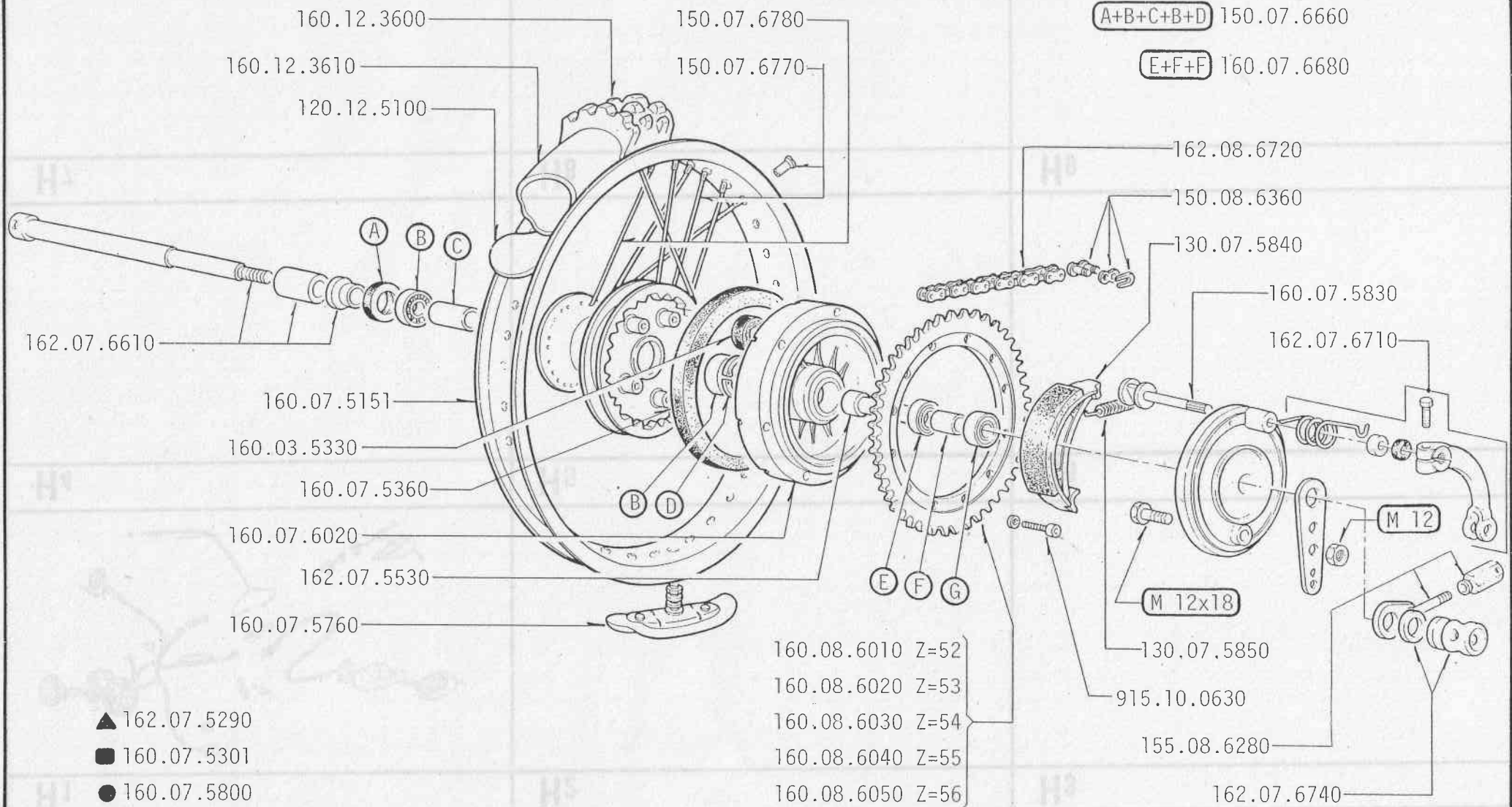
FANTIC
MOTOR

▲ 162.07.5290

■ 160.07.5301

● 160.07.5800

▲ Ruota posteriore completa
 ■ Mozzo posteriore completo
 ● Disco portaceppi posteriore completo

▲ Roue arrière complète
 ■ Moyeu arrière complet
 ● Disque porte-machoirs arrière complet

▲ Rear wheel complete
 ■ Rear hub complete
 ● Rear brake plate complete

▲ Hinterrad komplett
 ■ Hinterradnabe komplett
 ● Hinterradbremssplatte komplett

L**CABALLERO 50 cc**
REGOLARITÀ COMPETIZIONE

6 - 1979

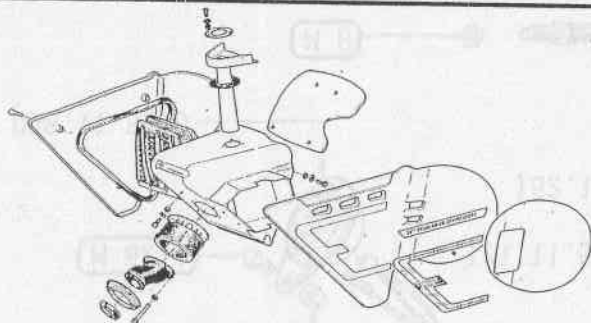
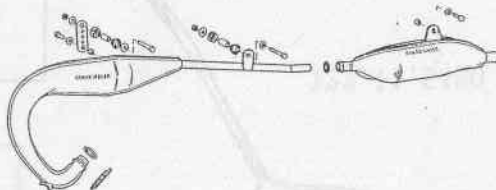
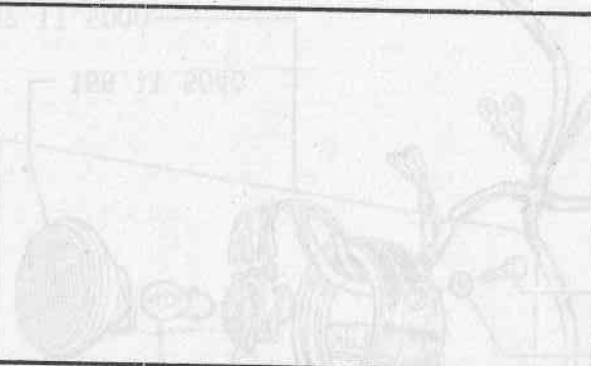
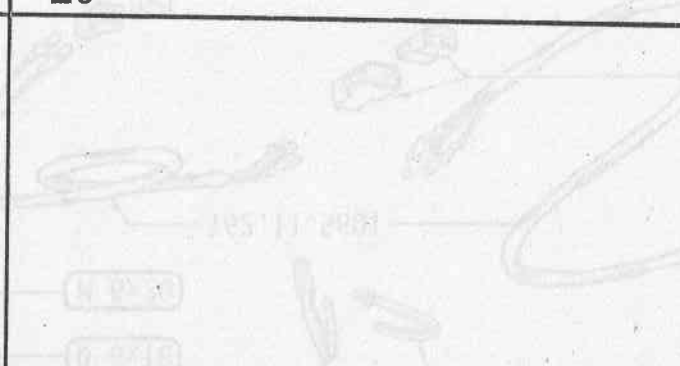
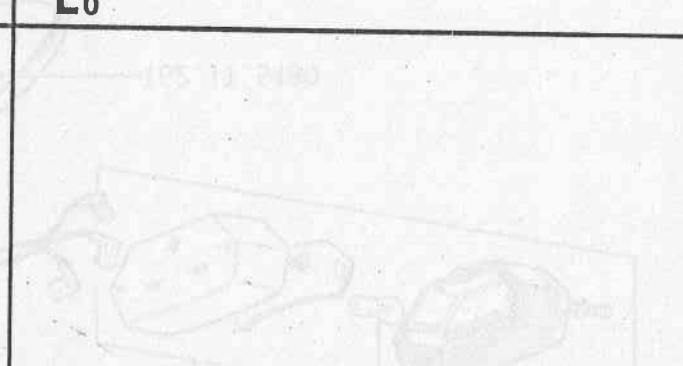
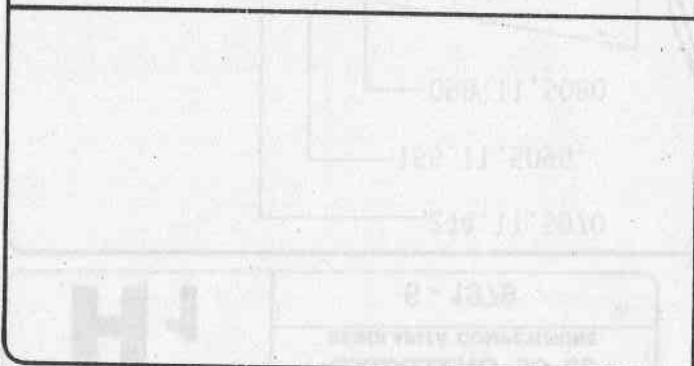
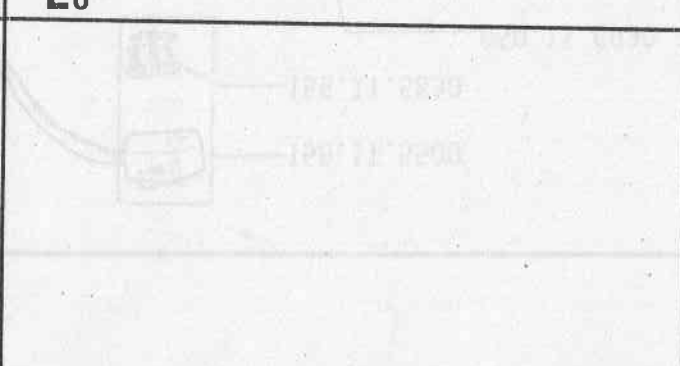
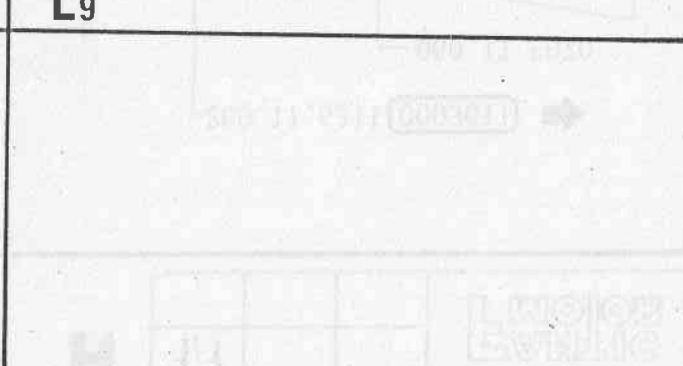
GRUPPO ASPIRAZIONE-CAMERA D'ESPANSIONE-SILENZIATORE
GROUPE ASPIRATION-POT D'ECHAPPEMENT-SILENCIEUX
GROUPE INTAKE-SILENCER-TERMINAL SILENCER
ANSAUGBAUGRUPPE-AUSPUFF-AUSPUFFSCHALLDAMPFER**FANTIC
MOTOR****L1****L2****L3****L4****L5****L6****L7****L8****L9**

L1

CABALLERO 50 cc
 REGOLARITÀ COMPETIZIONE
 6 - 1979

L

1/1

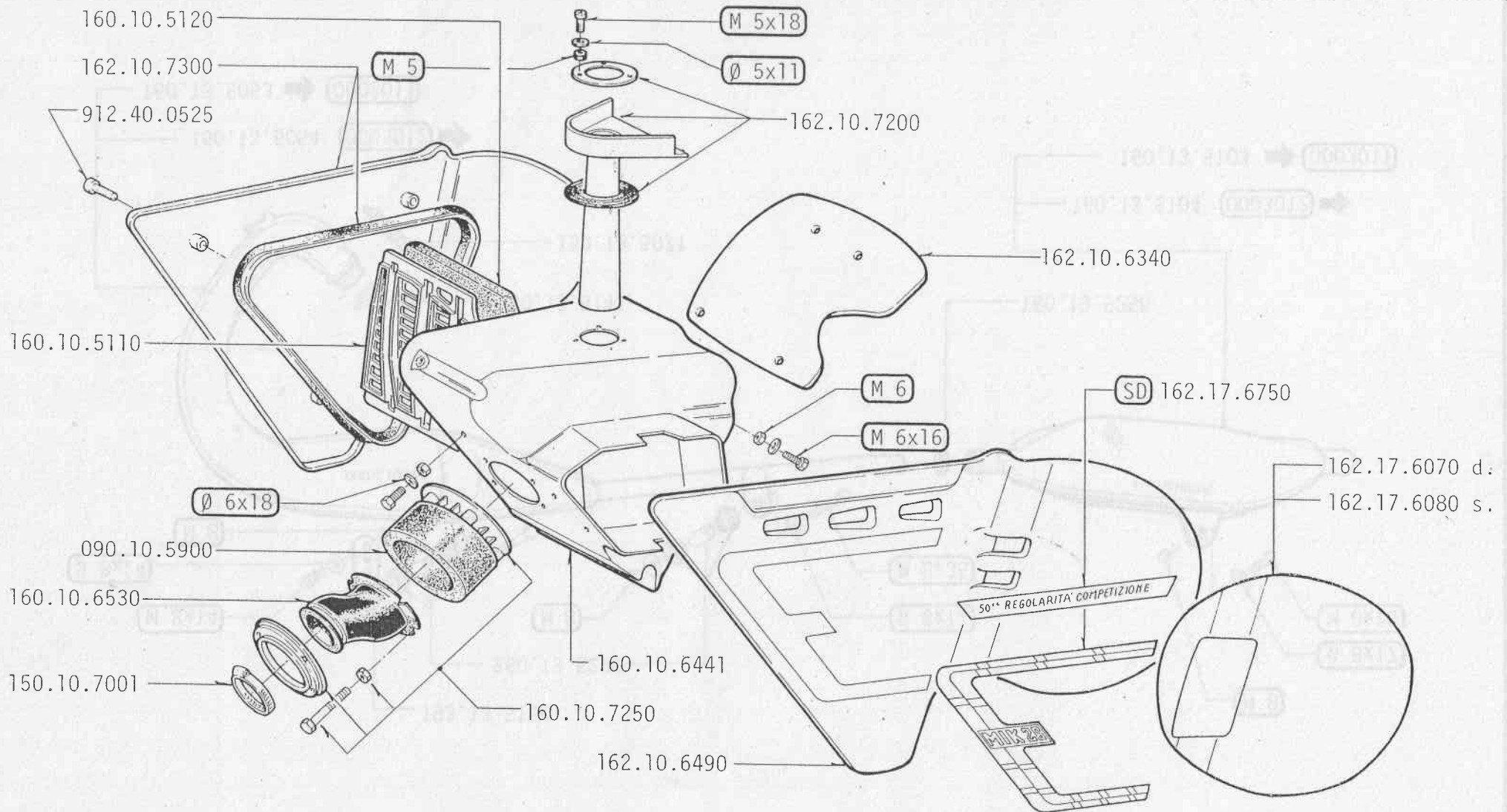
**FANTIC
MOTOR**

▲ 162.10.6801

▲ Gruppo di aspirazione completo

▲ Groupe aspiration complet

▲ Group intake assembly

▲ Ansaugbaugruppe Komplet

L2

CABALLERO 50 cc
REGOLARITÀ COMPETIZIONE

6 - 1979

L

2/1

FANTIC MOTOR

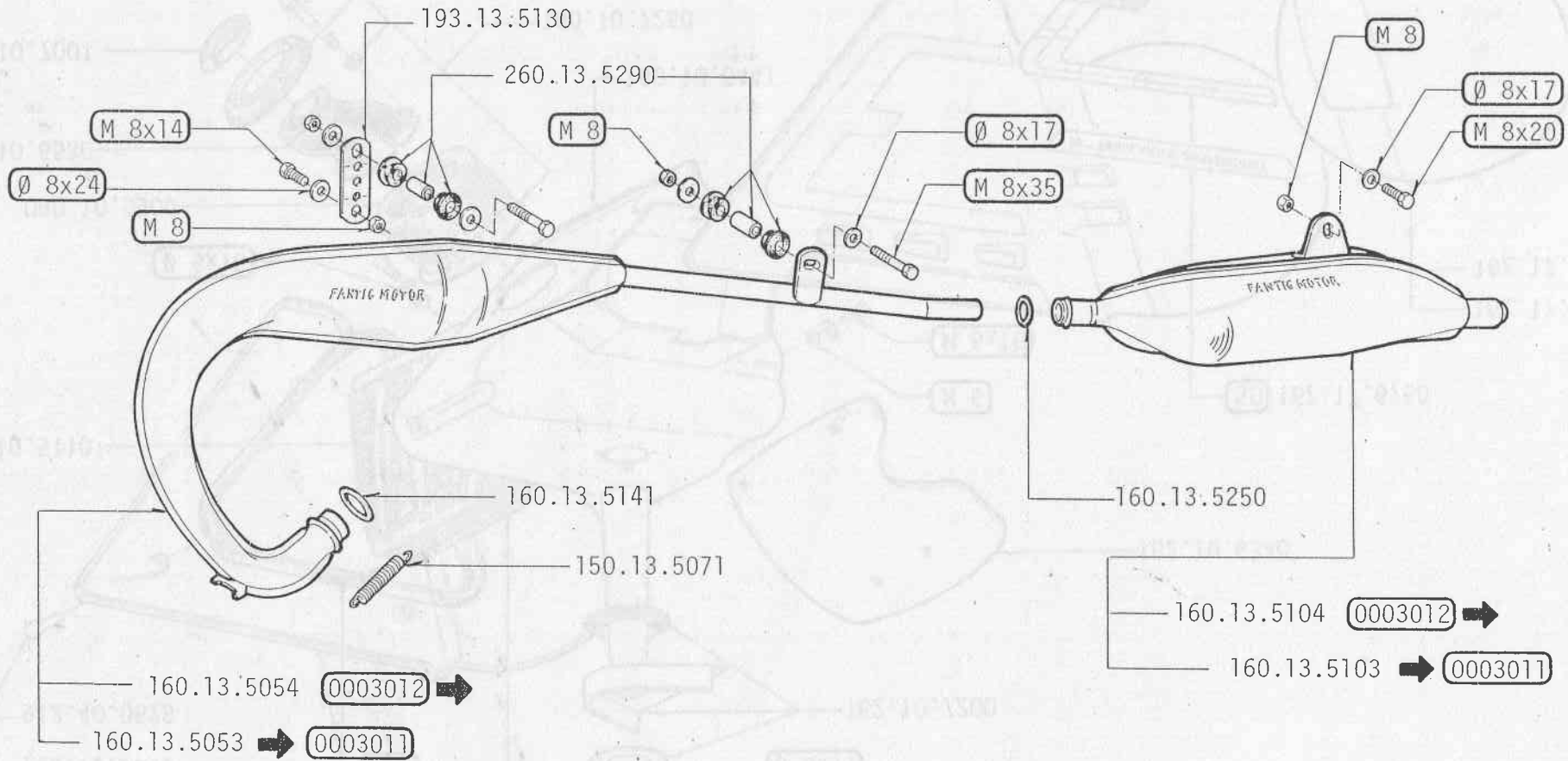

M1

CABALLERO 50 cc
REGOLARITÀ COMPETIZIONE

6 - 1979

M

1/1

FANTIC MOTOR

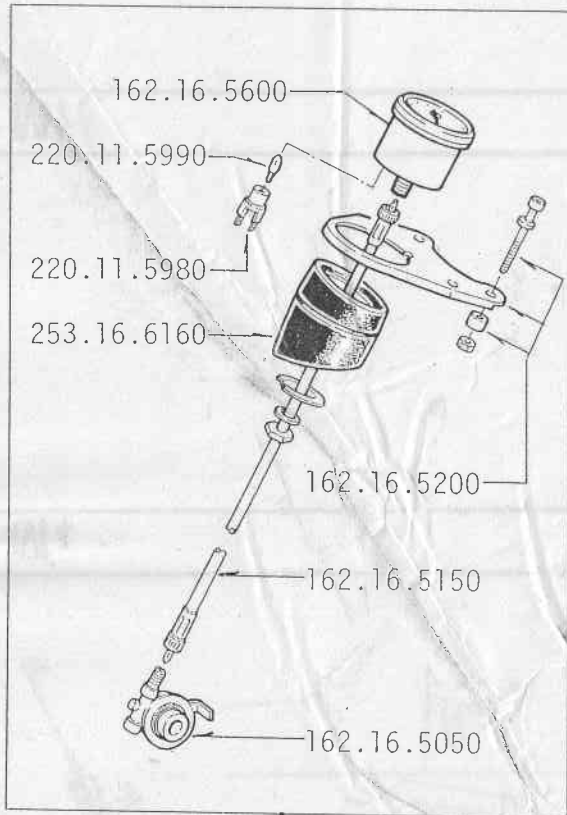

162.16.6600

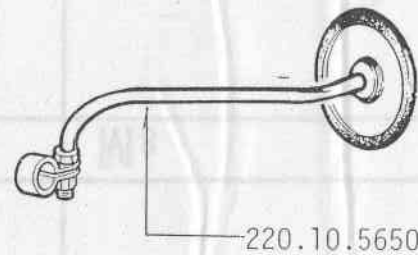

164.06.5000

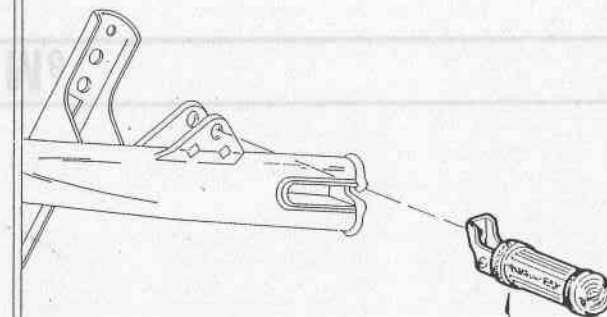
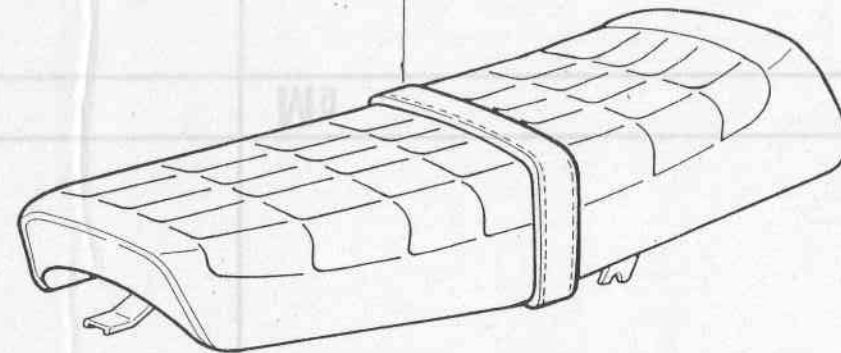

196.03.6200

N**CABALLERO 50 cc**
REGOLARITÀ COMPETIZIONE

6 - 1979

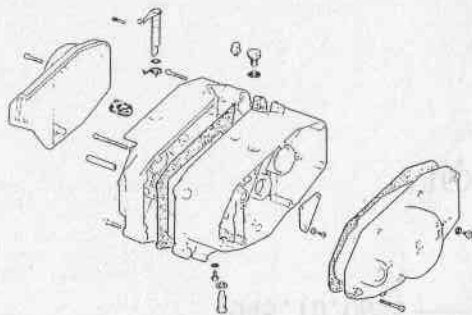
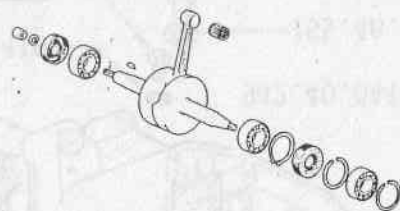
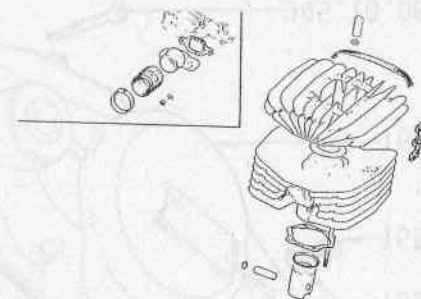
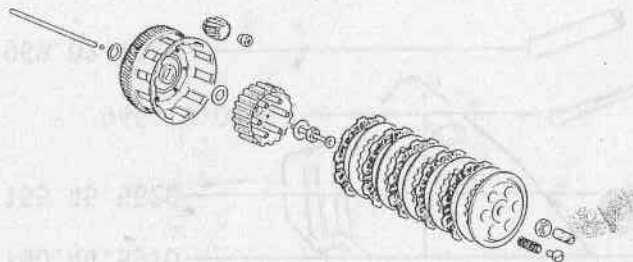
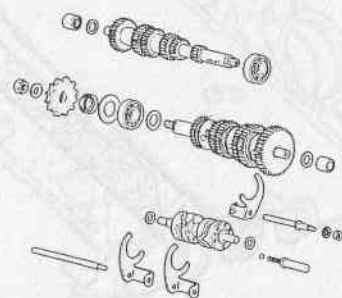
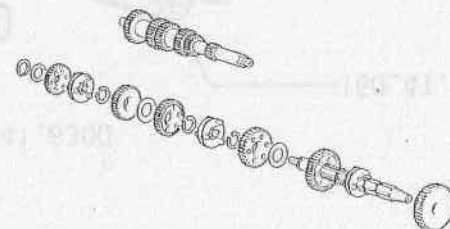
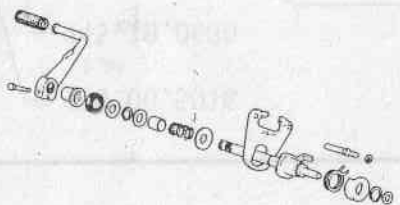
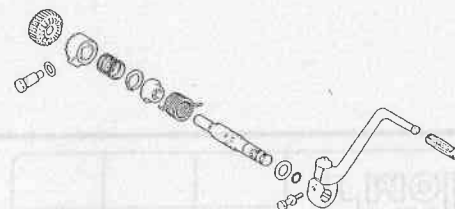
MOTORE
MOTEUR
ENGINE
MOTOR**FANTIC
MOTOR****N1****N2****N3****N4****N5****N6****N7****N8****N9**

N1

CABALLERO 50 cc
REGOLARITÀ COMPETIZIONE

6 - 1979

N

1/1

FANTIC MOTOR

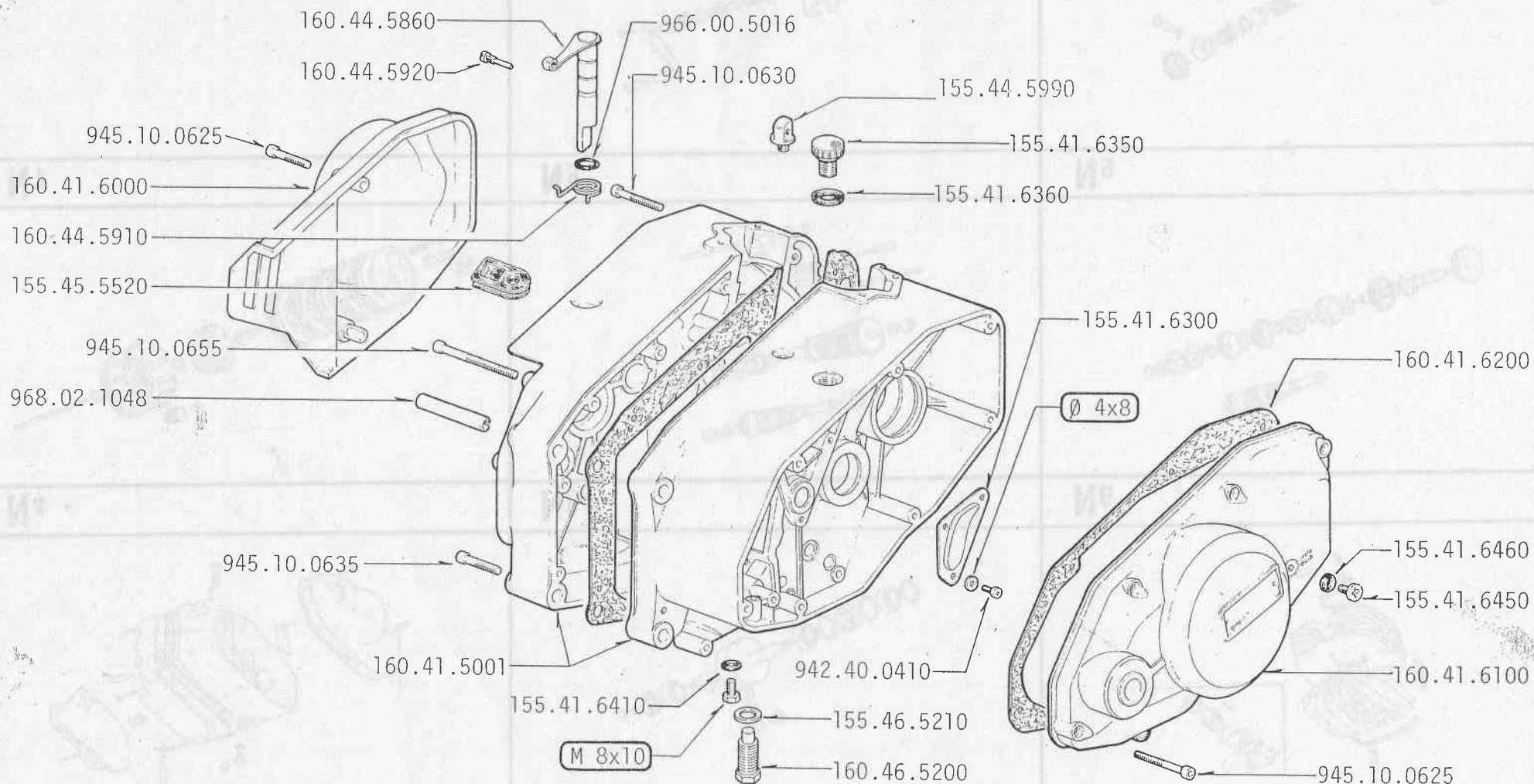

SG 160.41.6251

N2

CABALLERO 50 cc
REGOLARITÀ COMPETIZIONE

6 - 1979

N

2/1

FANTIC MOTOR

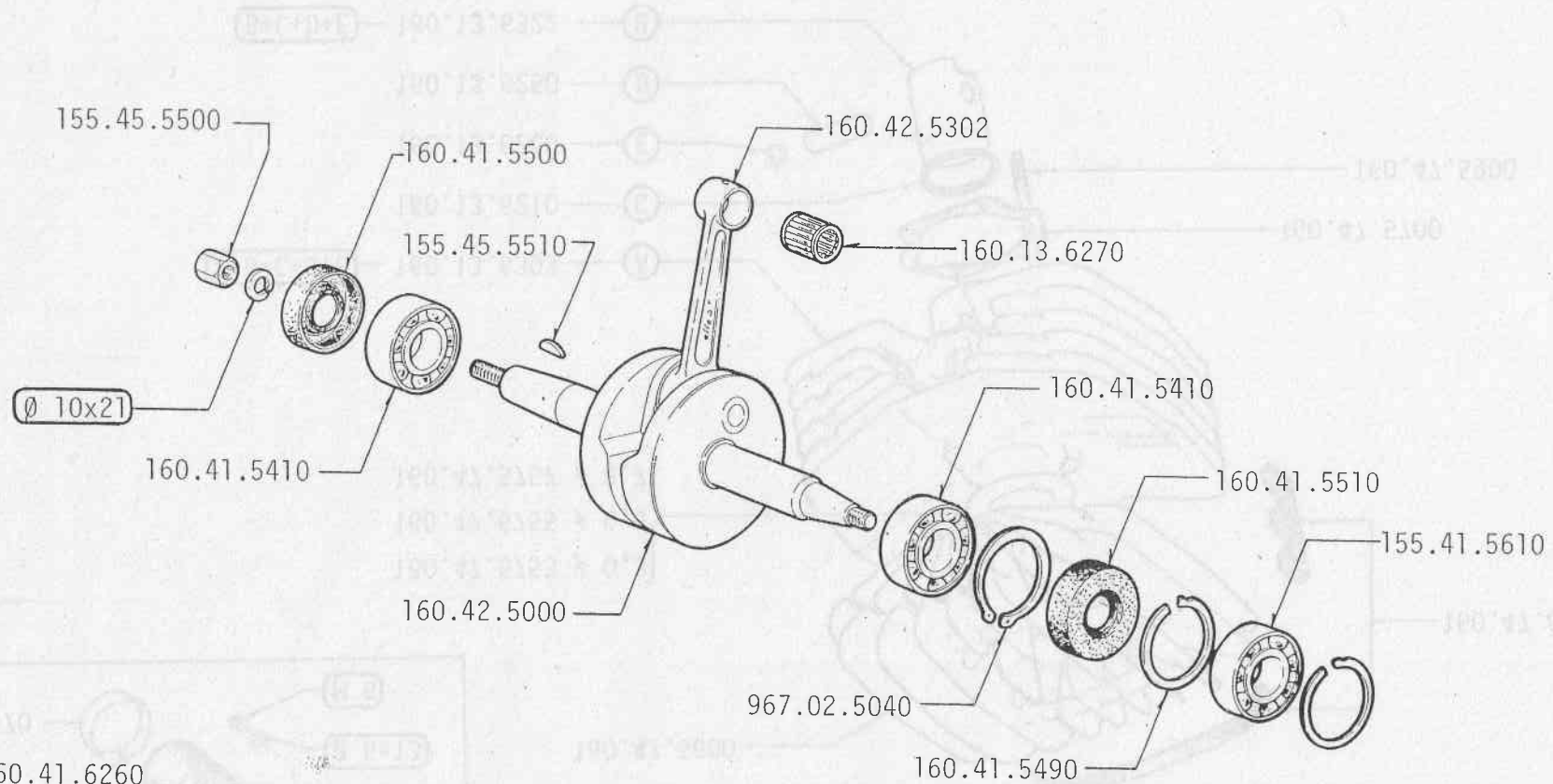

N3

CABALLERO 50 cc
REGOLARITÀ COMPETIZIONE

6 - 1979

N

3/1

FANTIC MOTOR

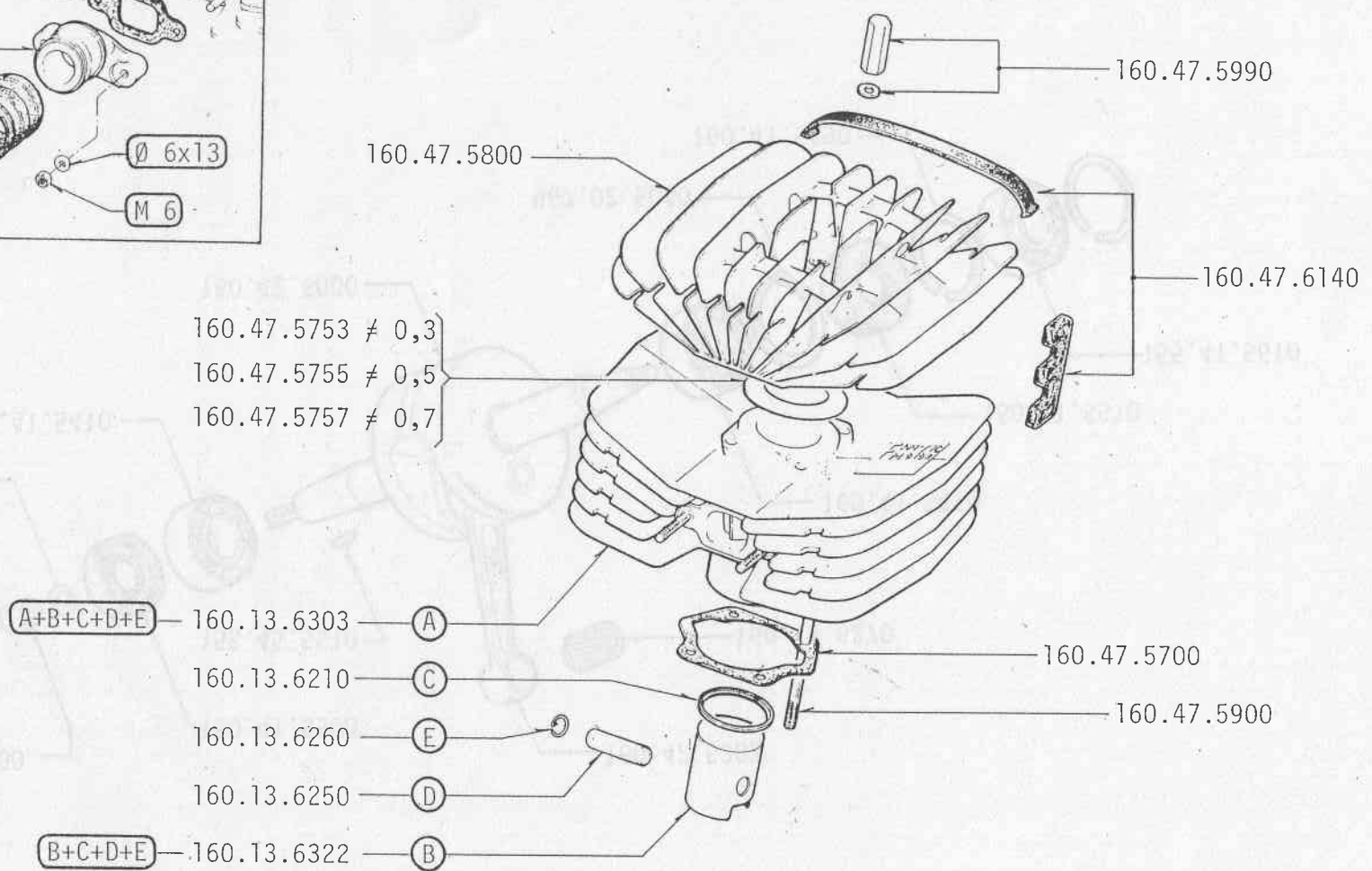
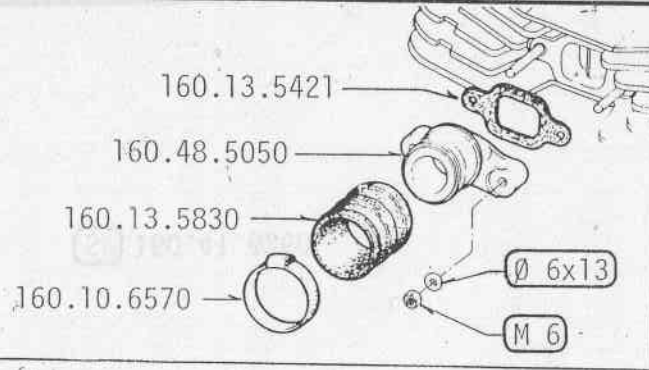

N4

CABALLERO 50 cc
REGOLARITÀ COMPETIZIONE

6 - 1979

N

4/1

FANTIC MOTOR

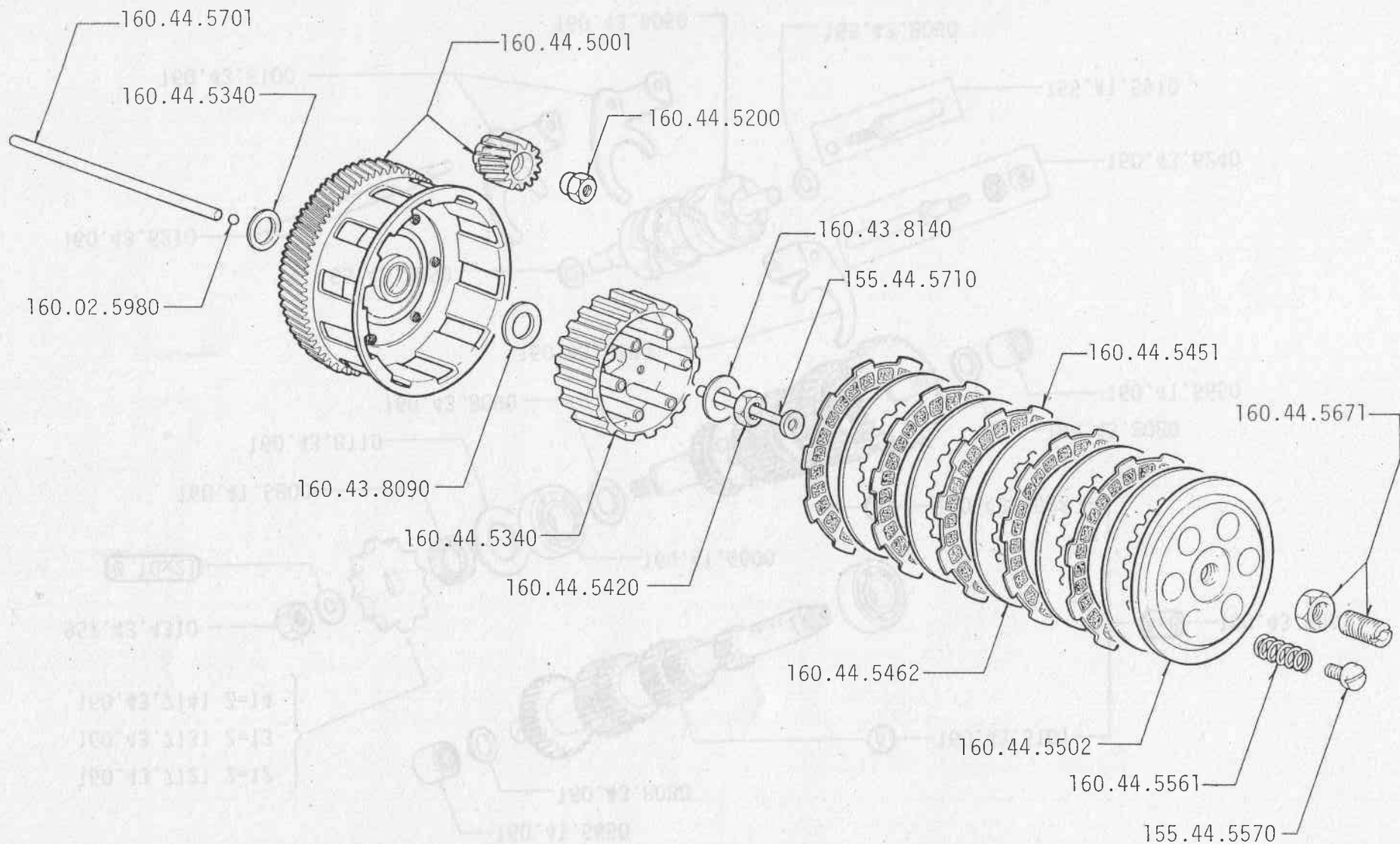

N5

CABALLERO 50 cc
REGOLARITÀ COMPETIZIONE

6 - 1979

→ 0002935

N

5/1

FANTIC MOTOR

P Tav. N5/2

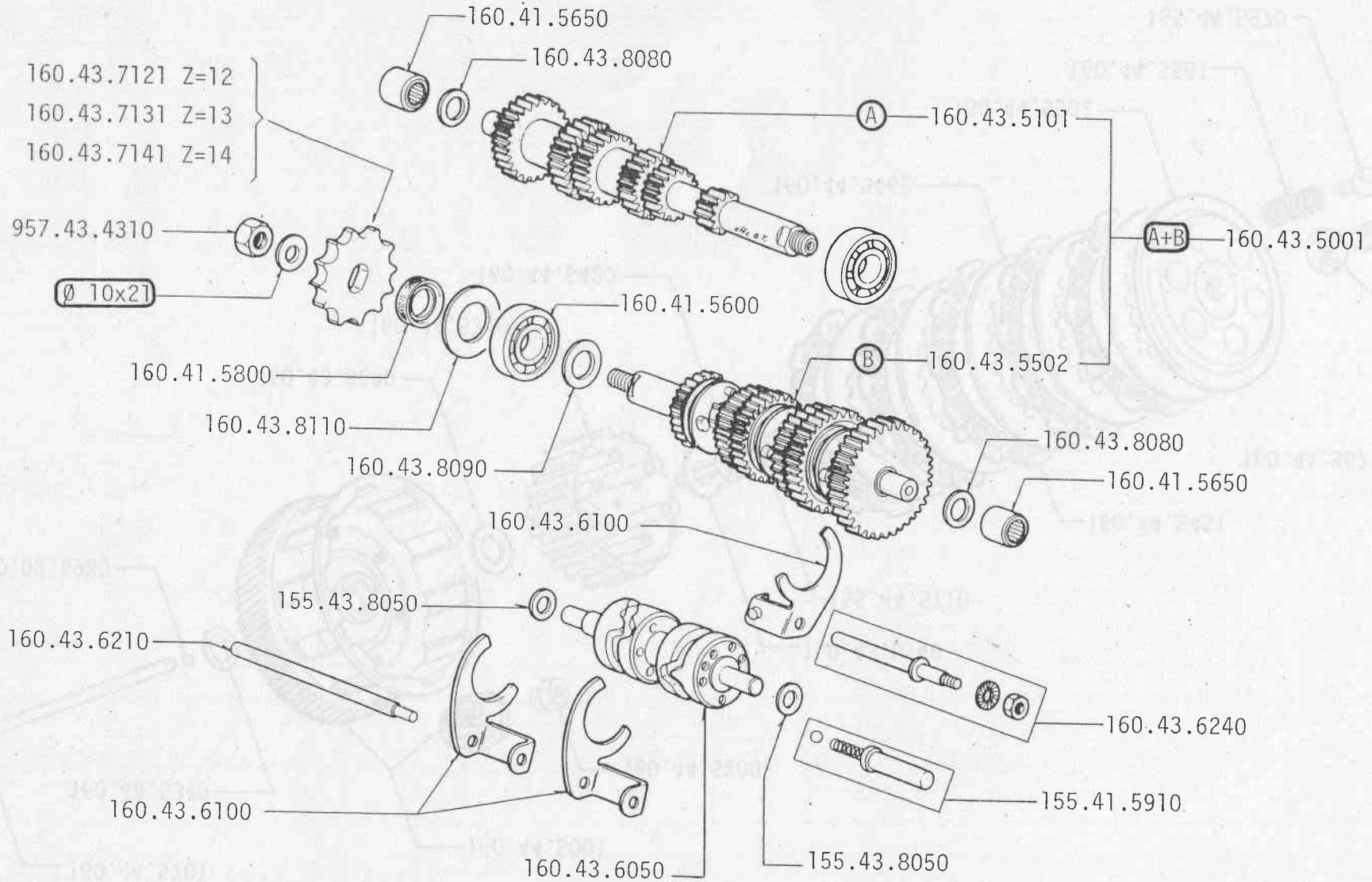

N5

8 - 1979
REGOLARITÀ COMPETIZIONE
CABALLERO 50 cc

N

5/1

FANTIC MOTOR

N5

CABALLERO 50 cc
REGOLARITÀ COMPETIZIONE
6 - 1979

0002936 →
A Tav. N./1

N

| | | |
|-----|-----|--|
| 5/1 | 5/2 | |
| | | |

FANTIC MOTOR

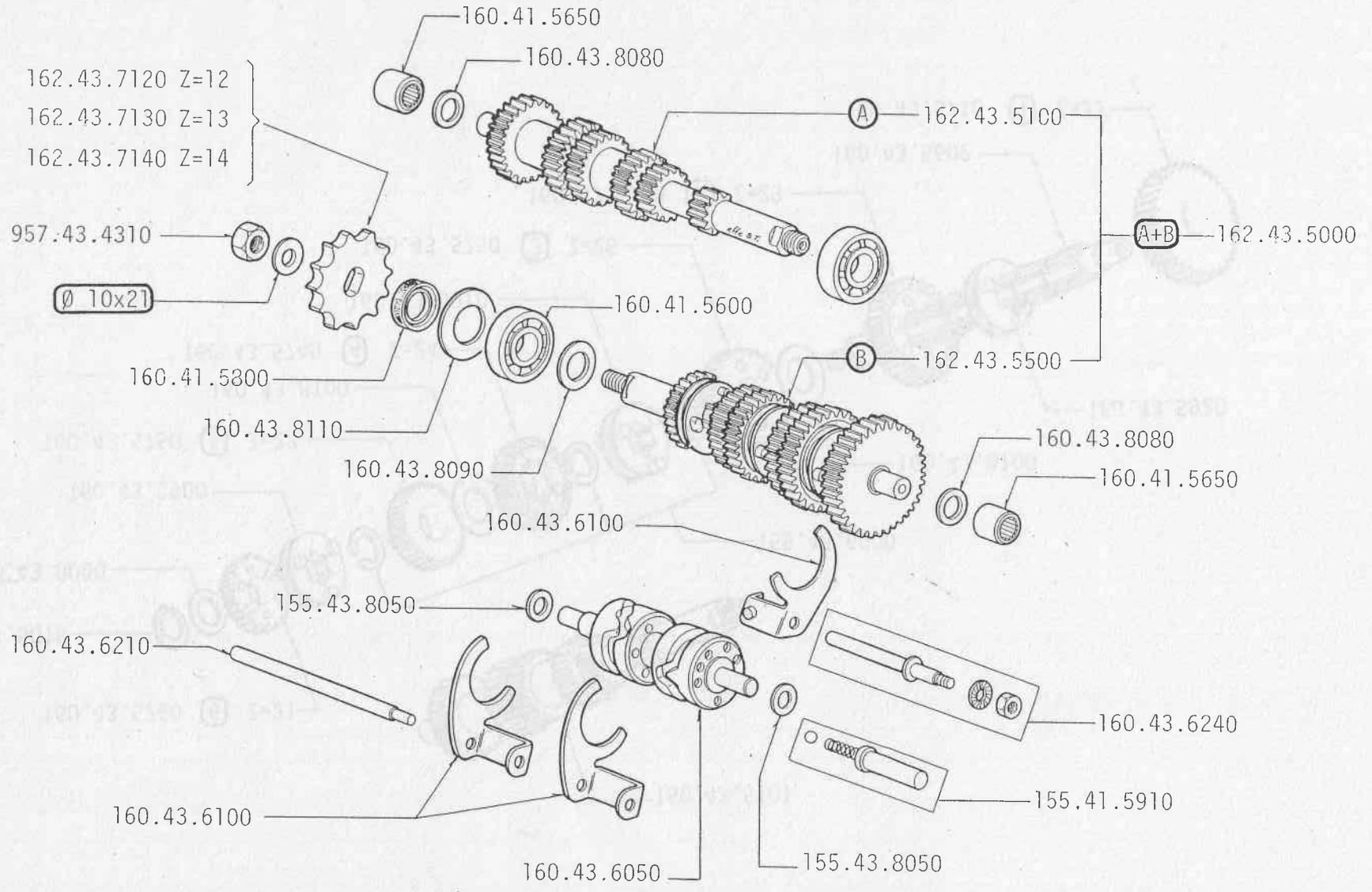

N6

CABALLERO 50 cc
REGOLARITÀ COMPETIZIONE

6 - 1979

→ 0002935

P Tav. N6/2

N

6/1

FANTIC MOTOR

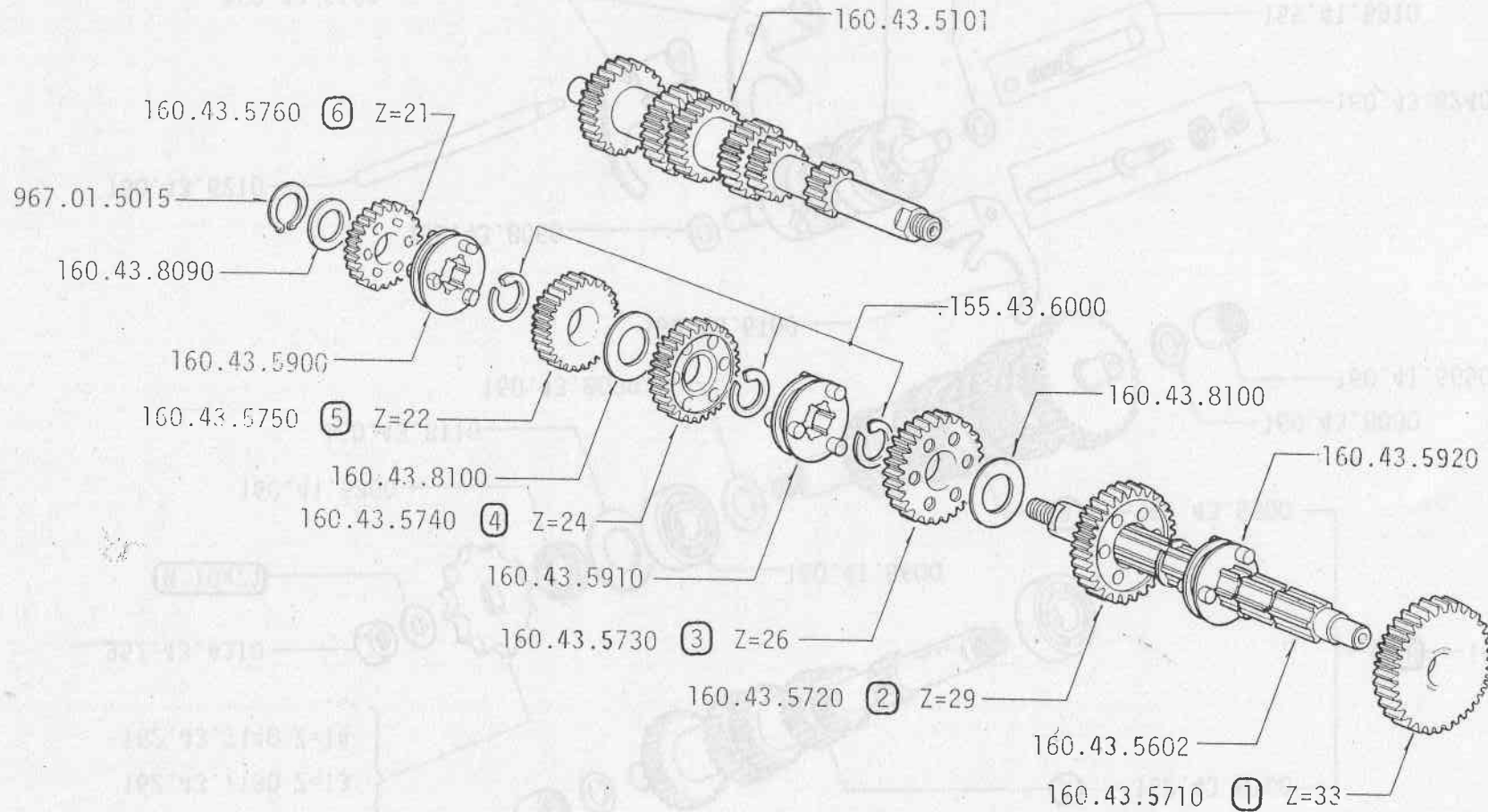

N6

CABALLERO 50 cc
REGOLARITÀ COMPETIZIONE

6 - 1979

0002936 →

A Tav. N6/1

N

6/1

6/2

FANTIC MOTOR

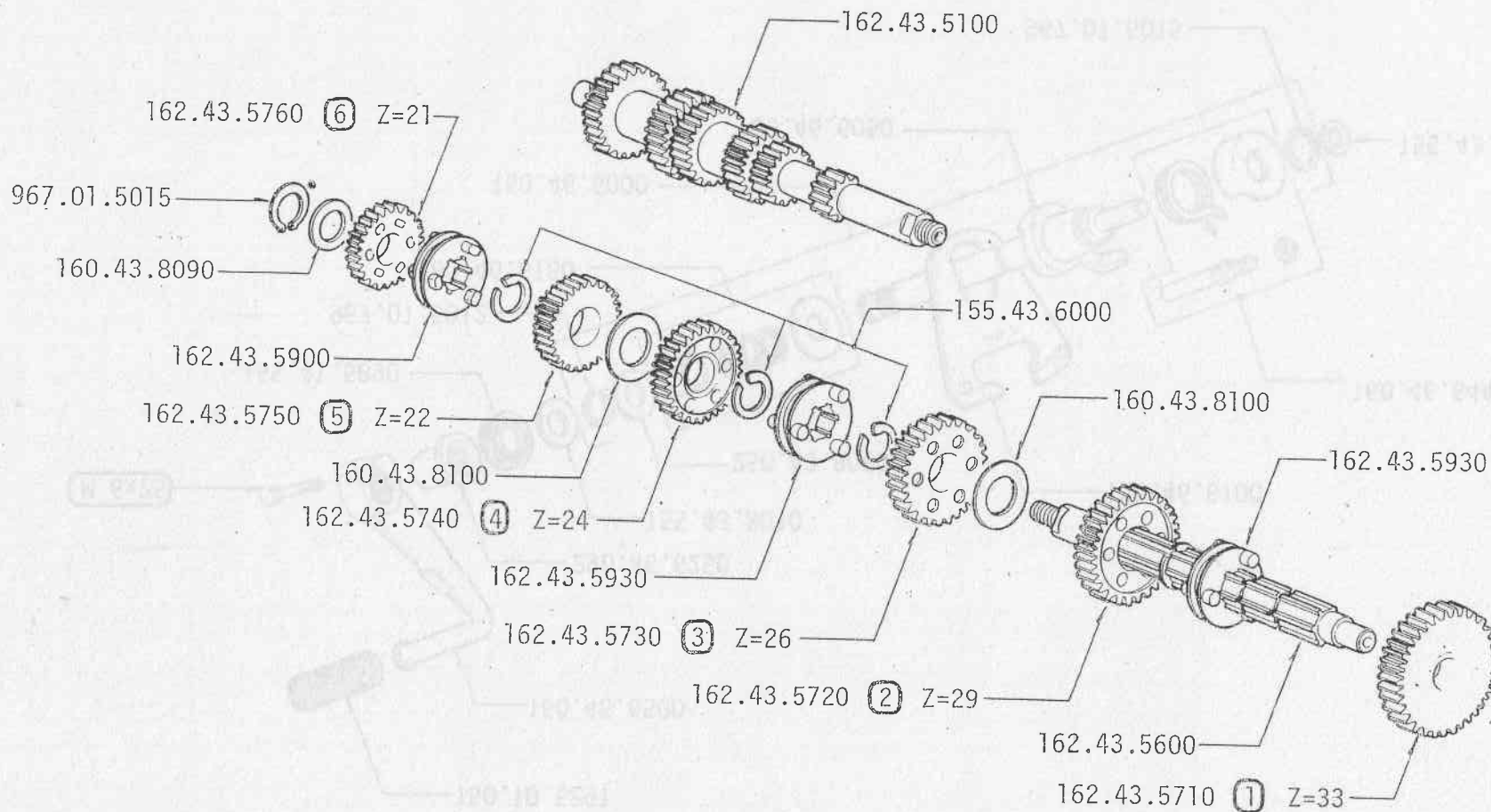

N8

CABALLERO 50 cc
REGOLARITÀ COMPETIZIONE

6 - 1979

N

8/1

FANTIC MOTOR

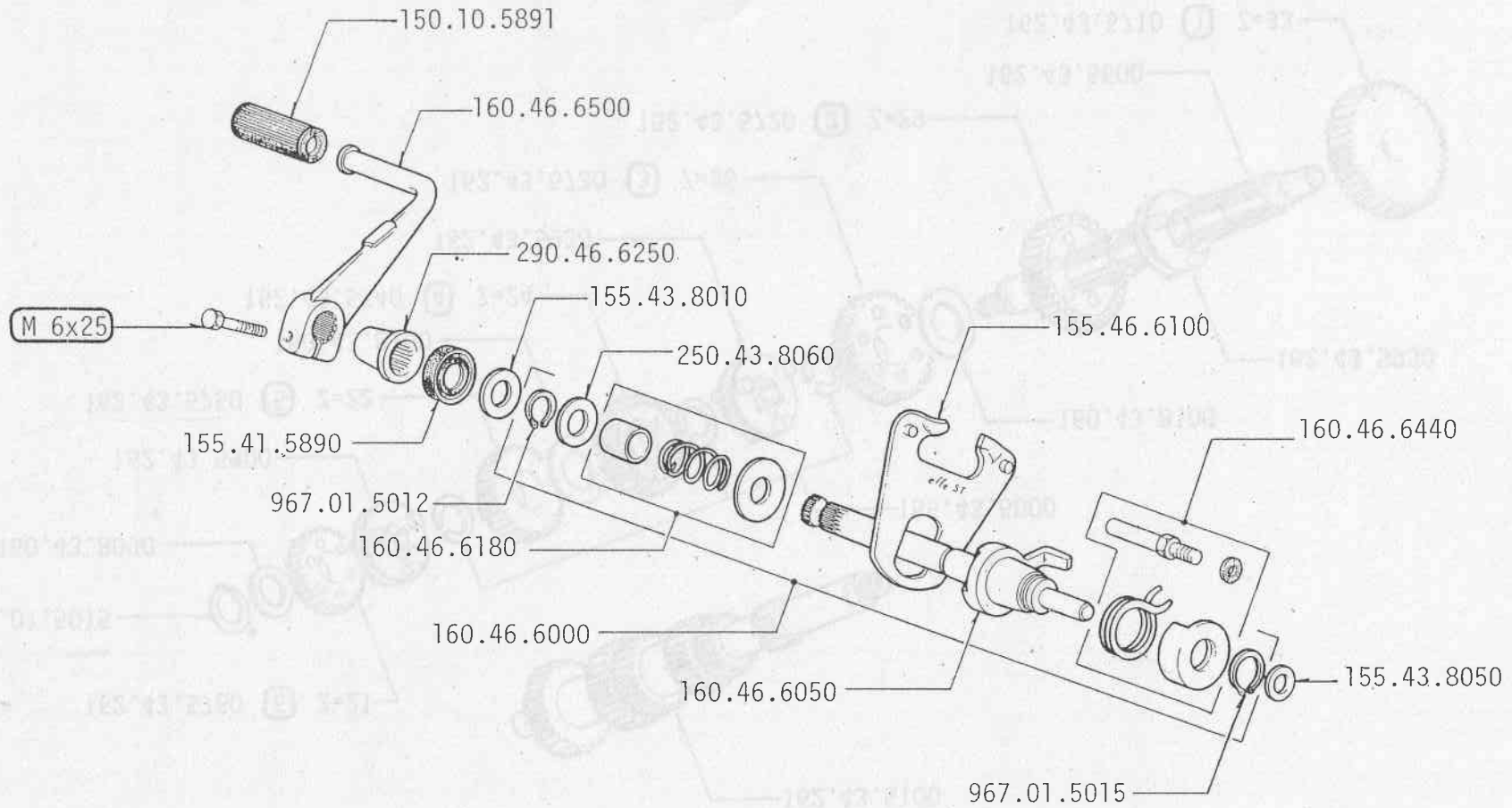

N9

CABALLERO 50 cc
REGOLARITÀ COMPETIZIONE

6 - 1979

N

9/1

FANTIC MOTOR

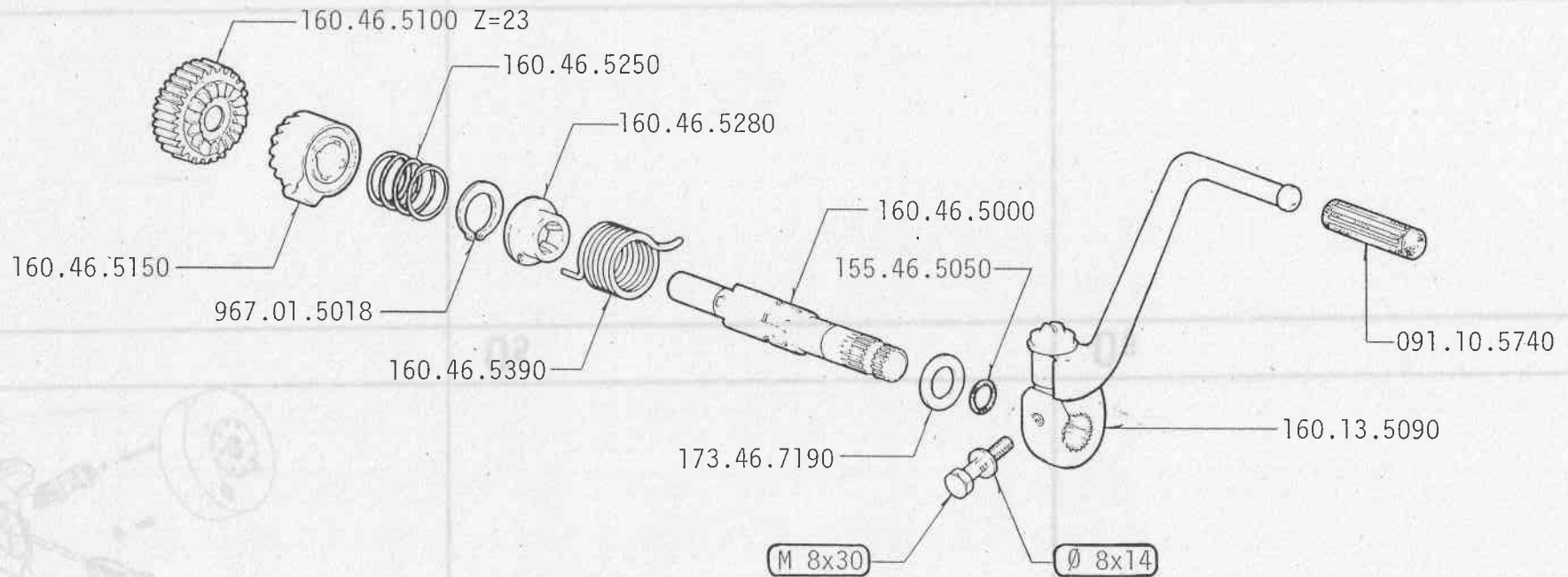

01

CABALLERO 50 cc
REGOLARITÀ COMPETIZIONE

6 - 1979

0

1/1

**FANTIC
MOTOR**

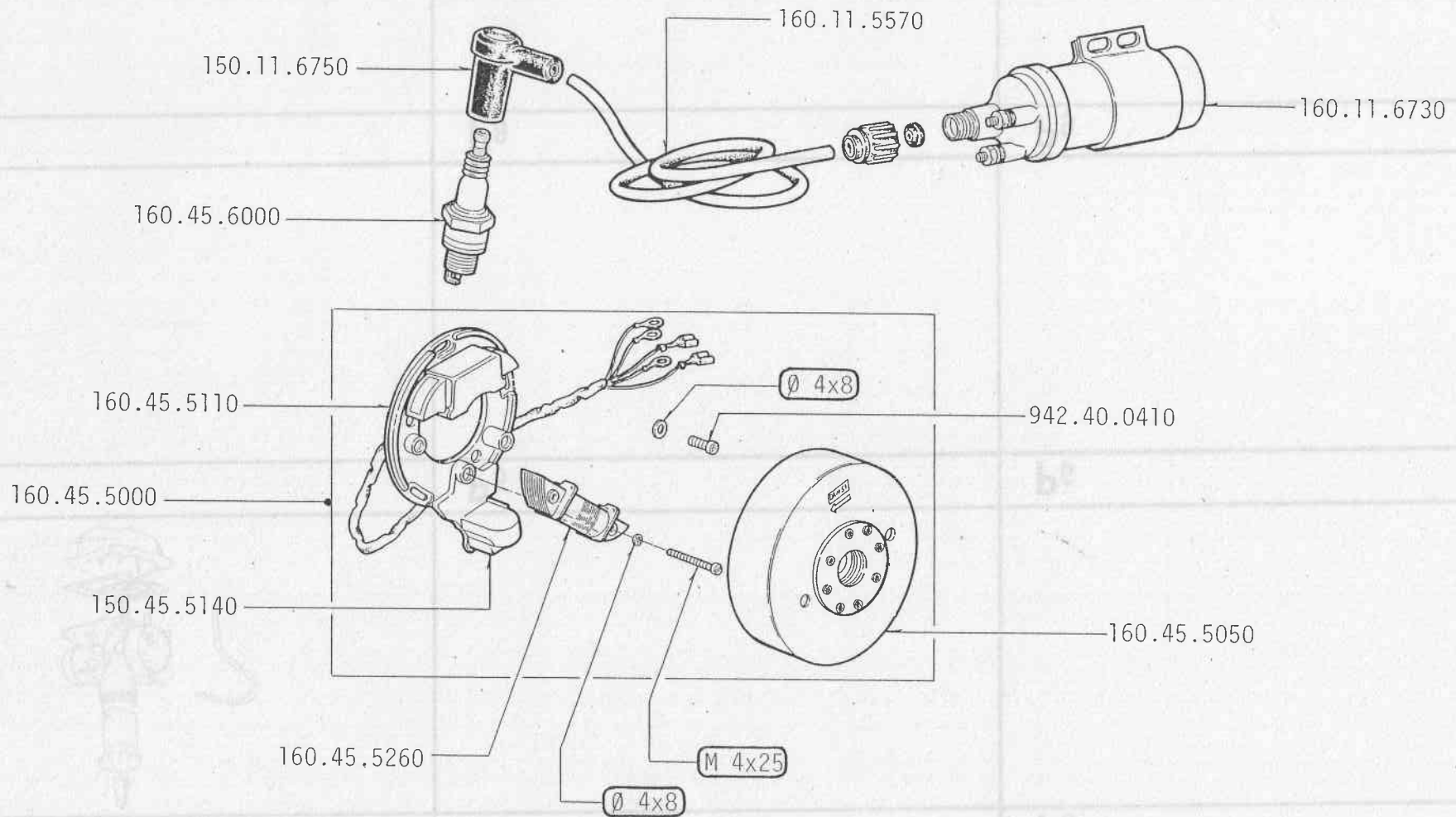

CABALLERO 50 cc
REGOLARITÀ COMPETIZIONE

6 - 1979

P1

FANTIC
MOTOR

1/1

P

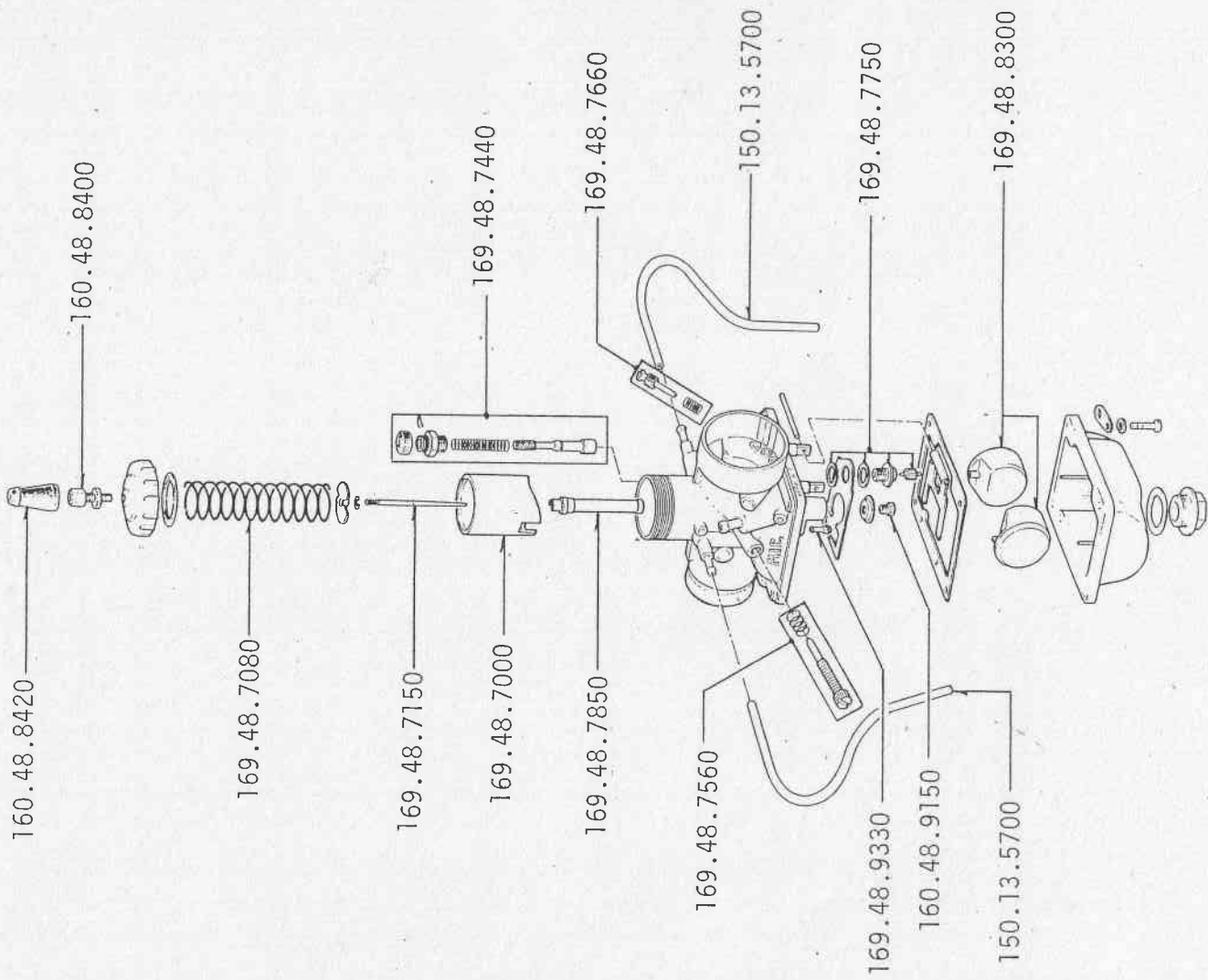

SG 169.48.5040

▲ 160.48.5000

▼ Carburatore completo

▼ Carburateur complet

▼ Carburator complet

▼ Vergaser komplett